

HUMAN  
CHALLENGES  
IN A CONTEXT  
OF CHANGING  
LANDSCAPES

# SCIENTIFIC PROGRAMME

LANDSCAPE  
ARCHAEOLOGY  
CONFERENCE

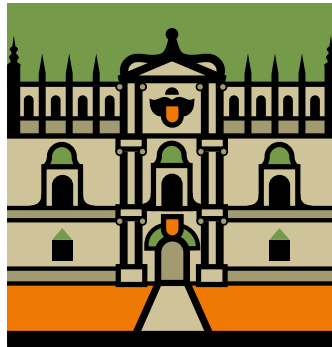

# LAC 2024

10-14 JUNE  
ALCALÁ UNIVERSITY  
SPAIN

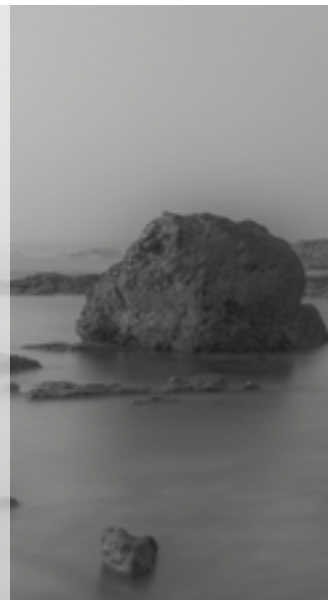



ALCALÁ UNIVERSITY  
COLEGIO DE SAN ILDEFONSO- RECTORADO

Plaza de San Diego, s/n  
28801, Alcalá de Henares, Madrid

COLEGIO DE MÁLAGA  
FACULTAD DE FILOSOFÍA Y LETRAS

Calle Colegios, 2  
28801 Alcalá de Henares, Madrid



WEB EVENT

# INDEX



## LAC 2024

### PAGES

Pages **2-3**

Pages **4-5**

Page **6**

Page **7**

Pages from **8 to 59**

Pages **60-61**

Pages **62-63**

Pages from **64 to 67**

Pages from **68 to 71**

Pages **72-73**

Pages **74-75**

Pages **76-77**

### SECTIONS

WELCOME LAC2024 PARTICIPANTS

GREETINGS FROM THE LAC2024

IALA

ORGANIZING COMMITTEE

PARALLEL SESSIONS

POSTER SESSION

CONFERENCE FIELD TRIPS

SCHEDULE

MAPS OF THE VENUE

PRACTICAL INFORMATION

GUIDELINES FOR PRESENTERS

GUIDELINES FOR PARALLEL SESSION CHAIRS

10-14 JUNE. ALCALÁ UNIVERSITY. SPAIN

HUMAN CHALLENGES IN A CONTEXT OF CHANGING LANDSCAPES

WELCOME LAC2024  
PARTICIPANTS



Dear LAC2024 participants

Welcome to the **8<sup>th</sup> Landscape Archaeology Conference, LAC2024, in Alcalá de Henares, Spain**, that is already promising to be a huge success. This week more than 300 registered delegates coming from many different disciplines, countries and multiple continents will be delivering key notes, oral presentations, posters and discussions in more than 30 sessions as well as an excursion.

Four years ago we were also planning to visit Madrid, Spain with LAC2020, but we were hit by the Covid-19 pandemic and the local organisers had to postpone the conference to an online version of LAC2020+1 in June 2021. More than a year later also the LAC2022 conference in Iasi, Romania was mainly online because of the enduring pandemic that still prohibited much travel and live meetings.

Fourteen years ago we started the LAC series in 2010 at the Vrije Universiteit Amsterdam, The Netherlands, with six themes in three days and an excursion. Out of nothing a solid group of more than 200 (geo-)archaeologists, physical and historical geographers, as well as commercial archaeologists was established and promised to be the starting point of a biannual conference series. The LAC travel of landscape archaeologists has brought us from Amsterdam (2010), Berlin (2012), Rome (2014), Uppsala (2016), Durham/Newcastle (2018), Madrid (2021 online), Romania (2022, online) finally to here near Madrid in Alcalá de Henares in 2024.

Landscape archaeology will be deepened and explored further in this conference. We started with the concept of landscape as a platform for interdisciplinary research with questions from what is nature, to what is human impact and now to what future lies ahead for global landscapes in a rapidly changing world due to climate change, biodiversity loss and ongoing unrest and uncertainty in economic, social and political consequences. At the same time



we are awaiting excellent interdisciplinary sessions in landscape archaeology ranging from environmental archaeology to heritage, from food to digital archaeology, from people, myths and belief to mobility, and from future sustainability to developing methodologies in multiple world-wide regions over variable timescales.

The International Association of Landscape Archaeology, established in 2017, in short IALA, offers to bridge the gap between humanities and sciences and promote an international and interdisciplinary mode of landscape archaeology. IALA supports the biannual organisation of LAC conferences, provides awards to young researchers, and has given out dissertation awards to stimulate the advancement of landscape archaeology. Membership of IALA makes these developments possible, as well as voting rights during the General Assembly, and we kindly ask you to consider such membership.

**The 30+ sessions at LAC2024** will bring us a true integration of methodologies and the maturity of the discussion in landscape archaeology, and how to value the different disciplines and to continue the discussion in a wider context. We wish you, the LAC participant an interesting conference to contribute with us to create the building blocks of interdisciplinary landscape archaeology. We wish you also a big success by making every session an interdisciplinary event where multiple disciplines will be debating the research. Thanks again for this great scientific happening in Alcala de Henares, make your research sustainable, and build on these results in the future!

**22-5-2024, Amsterdam, The Netherlands**

Associate Professor in Geoarchaeology and Anthropocene Studies,

**Sjoerd Kluiving**, President IALA

10-14 JUNE. ALCALÁ UNIVERSITY. SPAIN

HUMAN CHALLENGES IN A CONTEXT OF CHANGING LANDSCAPES

GREETINGS  
FROM THE LAC2024  
ORGANIZING COMMITTEE



Dear participants,

We are delighted and honored to welcome you to the **2024 Landscape Archaeology Conference**, taking place in Alcalá de Henares, Spain, from 10th to 14th June. We are very happy to share these days with you.

When the Consejo Superior de Investigaciones Científicas and the Universidad de Alcalá proposed that the 2024 meeting of the International Association of Landscape Archaeology should be held in this city and the historic buildings of its university, we never expected the complexities and challenges that we would face - especially considering that we have more than 300 participants!

The conference aims to follow on from LAC2020+1, which was based in Madrid but due to the Covid pandemic was finally held online. LAC2024 has gathered an important number of international participants with an emphasis on interdisciplinary work. In fact, under the title 'Human challenges in a context of changing landscapes', we are happy to say that we have brought together a vast number of interdisciplinary and multidisciplinary studies in Landscape Archaeology.



There is still much to do in the research on landscape transformation and we hope that these days will serve to exchange and to disseminate ideas and experiences that will allow us to advance in our contribution to Landscape studies. We also hope that the Alcalá de Henares location, one of the most beautiful cities in Spain, will be inspiring for new questions and new perspectives in our research. Indeed, we are convinced that the historic buildings of its university, founded in 1499, together with the Museo Arqueológico Regional de la Comunidad de Madrid, constitute an excellent venue to celebrate an international conference such as the Landscape Archaeological Conference.

This meeting should provide an opportunity for fruitful and peaceful collaboration and show that dialogue is the best possible tool that we have as researchers. Please let us work together to keep this dialogue open and to listen to what everyone has to say.

Looking forward to a productive conference!

Best wishes,

**The Organizing Committee**

***Pilar Diarte-Blasco, Almudena Orejas, Brais X. Currás*** Instituto de Historia, CSIC

***Primitiva Bueno Ramírez, Manuel Castro-Priego,*** University of Alcalá

IALA



**NICE TO KNOW:**

• **The International Association of Landscape Archaeology (IALA)** is an association aiming at promoting interdisciplinary research in the field of landscape archaeology. IALA provides a platform for archaeologists, cultural and earth scientists and researchers from neighbouring disciplines to present and discuss results from this broad field of landscape research between the sciences and humanities.

• **IALA aims at values of higher interdisciplinary education**, expert and scientific research with emphasis on young scientists and mentors and explores possibilities of use of European funds for higher education purposes. The activities of the Association are directed toward mutual collaboration of all scientific institutions, professors, teachers, assistants and young scientists everywhere around the world.

• **Join IALA today! Benefits for IALA members include:**

**a)** Participation in the plenary session during the General Assembly, **b)** Voting rights in elections to the IALA Board and for any statutory change, **c)** Free Online access to 'Landscapes', **d)** Free give-aways, e.g. IALA key-chain, **e)** Multiple awards for IALA members for travel, support Article Processing Charges and prizes for best Doctoral Dissertation, **f)** (for students) participation in IALA Student Council





ORGANIZING  
COMMITTEE



***Dr. Pilar Diarte-Blasco***

Spanish National Research Council (CSIC)  
Scientific and Organizing Committee Coordinator

***Dr. Almudena Orejas***

Spanish National Research Council (CSIC)

***Dr. Brais X. Currás***

Spanish National Research Council (CSIC)

***Dr. Manuel Castro Priego***

University of Alcalá

***Dr. Primitiva Bueno Ramírez***

University of Alcalá

## 10-14 JUNE. ALCALÁ UNIVERSITY. SPAIN

HUMAN CHALLENGES IN A CONTEXT OF CHANGING LANDSCAPES

### 10 June MONDAY

16:00-16:30 h

#### **LAC2024 Organizing Committee and Institutional Welcome**

16:30-17:15 h

#### **Inaugural Conference**

*Mike Parker Pearson, Institute of Archaeology, London*

**The Stonehenge landscape: new insights**

17:15-18:00 h

#### **Inaugural Conference**

*Helena Kirchner, Universitat Autònoma de Barcelona (Spain)*

**Building a new agrarian landscape in al-Andalus**

18:00- 18:45 h

#### **Event**

*Pedro Díaz del Río, Instituto de Historia, Spanish National Research Council (CSIC)*

**Funding Landscape Archaeology Research at the ERC**

19:00-20:30 h

#### **Welcome Reception**

### 11 June TUESDAY

17:00-19:30

**MUSEO ARQUEOLÓGICO Y PALEONTOLÓGICO**

#### **IALA General Assembly**



**SESSION 7.** Computational Approaches in Landscape Archaeology: Exploring Human-Environment Dynamics and Settlement Patterns from Prehistory to Recent Times

CHAIRS: *Mikel Díaz-Rodríguez; Cristian Lorenzo-Salgueiro; Miguel Carrero-Pazos*

8:30-8:50

**Defining the Influence of Environmental Variables on the Distribution of Palaeolithic Sites in Galicia**

*Mikel Díaz-Rodríguez*

8:50-9:10

**An approach to the locational analysis of Late Prehistory domestic sites in the Northwest of the Iberian Peninsula**

*Cristian Lorenzo Salgueiro; Carlos Rodríguez Rellán; Ramón Fábregas Valcarce*

9:10-9:30

**Unraveling Megalithic Networks: Exploring Landscape Movement Patterns in the Megalithic Complex of Galicia Through Computational Modeling**

*Miguel Carrero-Pazos; Devin W. White*

9:30-9:50

**Simulating social complexity in past landscapes: an agent-based model to test the circumscription theory**

*Santiago Tuñas-Corzón*

9:50-10:10

**Simulation of the Environment and Human Movement Routes Across the East Rim of the Tibetan Plateau in the Late Neolithic Age**

*Yidan Zhang*

10:10-10:30

Discussion •

**SESSION 34.** Open Session

CHAIRS: *Scientific Committee*

8:30-8:50

**Analyzing the landscape archaeology of the Susiana Plain during the 7200 to 4000 BCE through paleoclimatological evidence**

*Bijan Bajoorvand*

8:50-9:10

**Settlement Diversity: 3000 years of History in Menjez, Lebanon**

*Tara Steimer-Herbet; Alexandra Warminski; Filip Wałdoch*

11 June **TUESDAY**

9:10-9:30

**Testing settlement models in the Late Antique Egypt landscape of the Thebaid**

*Ariadna Guimerà; Pau de Soto Cañamares*

9:30-9:50

**Historical landscape and cultural enhancement. Integrated methods and technologies for the study and promotion of the middle ages in the verbanco area**

*Chiara Ribolla; Eleonora Casarotti; Stefano Martinella*

9:50-10:10

**A landscape and environmental study of historic charcoal production in West and South Yorkshire**

*Christopher Atkinson; Andrés Pérez Arana*

10:10-10:30

**Discussion •**

### ROOM 3

**SESSION 5. Community in the mining landscape: analysing human-environment interactions through a multidisciplinary approach**

CHAIRS: *Luisa Dallai; Mauro Buonincontri*

8:30-8:50

**The ancient anthropic activities in a mining district of Iberian Peninsula (San Juan de los Terreros, SE Spain)**

*Santiago Alejandro Romero García; Ignacio López Cilla; Yolanda Sánchez-Palencia; Trinidad Torres; Juan Pous de la Flor; Carlos Boente; Ana Blázquez; José Eugenio Ortiz Menéndez;*

8:50-9:10

**Bioarchaeology of Medieval mining community in Tuscany: ecosystem, resources and lifestyle at Rocca San Silvestro castle**

*Mauro Buonincontri; Serena Viva; Andrea Tommolini;*

9:10-9:30

**Cinnabar exploitation during the Late Neolithic in the mining landscape of Southern Tuscany (Italy): the case study of Poggio Spaccasasso mine and Mount Amiata.**

*Nicoletta Volante; Andrea Terziani; Matteo Faraoni; Chiara Boschi; Emma Cantisani; Fabio Fratini;*



9:30-9:50

**Cultural traits and material traditions. Gold-mining castros in north-western Hispania from Iron Age to Roman rural landscapes**

*Alicia Hernández-Tórtolas; Brais X. Currás; Almudena Orejas; Inés Sastre; Javier Sánchez-Palencia; Damián Romero;*

9:50-10:10

**Prehistoric flint mining landscape in Gargano (Apulia, Italy): mining markers and lithic evidence to analyse the process of flint exploitation**

*Giovanna Pizziolo; Carlo Tessaro; Andrea Terziani; Attilio Galiberti;*

10:10-10:30

Discussion •

ROOM 4

**SESSION 12.** Exploring the interaction between humans and their environment: The Roman road network and associated structures through Landscape Archaeology

CHAIRS: *Miriam González Nieto and José Luis Domínguez Jiménez*

8:30-8:50

**The Roman military presence in the hinterland of the Roman Limes. The casus of the Flemish part of het provinces Gallia Belgica and Germania Inferior**

*Heirbaut Elly*

8:50-9:10

**Roman road (re)construction in Germania inferior as an environmental and economic proxy: the case of cuijk and Utrecht (the Netherlands)**

*Toon Bongers; Eva Kars; Timo Vanderhoeven*

9:10-9:30

**Newly discovered roman routes in the eastern hinterlands of Thebes: the Coptite and Theban desert eastern hinterlands project**

*Mohamed Osman Abdollah*

9:30-9:50

**Itinera per Alpes: planning and building Roman roads through the Alpine landscape.**

*Michele Matteazzi*

9:50-10:10

**Cartographic research and surveys for the reconstruction of the ancient road system in the western Vercelli area**

*Eleonora Casarotti; Dario Anelli*

10:10-10:30

Discussion •

11 June **TUESDAY**

**ROOM 5**

**SESSION 20.** Ideology, production and social change. Forms of territorial organization during the 3rd to 1st centuries BCE

CHAIRS: *María Isabel Moreno Padilla; Susana González Reyero*

8:30-8:50

**Territorial organisation in Late Iron Age Gaul: Changing dynamics and nested identities**

*Manuel Fernández-Götz*

8:50-9:10

**The control and integration of the Cerretani under the Roman rule (s. II-I BC). Changes and continuities of the settlement patterns**

*Oriol Olesti Vila*

9:10-9:30

**The Configuration of an Ibero-Roman Landscape in Layetania (Barcelona) (3rd century BC – 1st century BC)**

*Juan Francisco Álvarez Tortosa*

9:30-9:50

**On the Local Roots of Roman Territorial Construction: A Proposal from the Territorium Dianensis**

*Ignasi Grau Mira; Joan Negre Pérez*

9:50-10:10

**Bellum iustum? War as a transforming factor in the Upper Guadalquivir territory**

*Carolina Castuera Bravo; Juan Pedro Bellón Ruiz*

10:10-10:30

**Discussion**

**ROOM 6**

**SESSION 1.** Farm, fold, shieling: environments, animal management and the transhumant systems in the North Atlantic región

CHAIRS: *Oscar Aldred; Egill Erlendsson; Árni Daníel Júlíusson; Gylfi Helgason*

8:30-8:50

**Archaeology of transhumant livestock practices in the north of the Iberian Peninsula**

*José Alberto Delgado Arcos; Pablo López Gómez; Margarita Fernández Mier*



8:50-9:10

**Mountain landscapes and settlements between seasonality, homing practices and animal farming: an archaeological perspective to the social construction of the space. Case studies from Southern Europe (16th-21st c.)**

*Anna Maria Stagno et al.*

9:10-9:30

**“When the Desert Met the River: On the importance of Desert and Wadi in the late Old Kingdom.”**

*John BURN*

9:30-9:50

**Land-use legacies of former transhumance – the case of Menstrie Glen, Scotland.**

*Sebastian Wolfrum*

9:50-10:10

**Mother Oak: Medieval Transhumance in South-East England a dependency on lowland wood-pasture**

*Andy Margetts*

10:10-10:30

**The Norwegian Shieling System - Continuity and Change in Transhumant practices in the Intersection between Humans, Environments and Landscapes**

*Kristoffer Dahle*

ROOM 7

**SESSION 9. Mobility, settlements and Archaeology: How ancient movements have shaped the Landscape?**

CHAIRS: *David Garcia-Casas; Thibault Saintenoy*

8:30-8:50

**From place-based to path-oriented approaches to interpreting pastoralist landscapes: Examples from eastern Africa**

*Paul Lane*

8:50-9:10

**A combined GIS and historical approach for the modelling and identification of medieval transhumant routes in South France**

*David García Casas; Sylvain Burri*

9:10-9:30

**Routeways of the North York Moors: Towards a Typology**

*David Stapley*

11 June **TUESDAY**

9:30-9:50

**An archaeobiographical approach of the river valley of the Schijn (Antwerp-Belgium): interdisciplinary research into the transformission of its landscape features in a suburban context**

*Tys Dries; Heirbaut Elly; Tops Bert; Vandebussche Vanessa; Dierckx Leen*

9:50-10:10

**Ancient Pathways: The Achaemenid Royal Road and Roman Roads Unveiling Movement Dynamics on the Anatolian Landscape**

*Mahnaz Sadeghipour; Farshid Iravani Ghadim*

10:10-10:30

Discussion•

## ROOM 8

**SESSION 22. Memoryscapes: Monuments, materiality, and the memorialisation of the landscape**

CHAIRS: *Marianna Negro; Julia Gustafson*

8:30-8:50

**Introduction and opening remarks**

*Marianna Negro; Julia Gustafson*

8:50-9:10

**The Falstad Forest – the memorialisation of a killing site from the Second World War in Norway**

*Kristoffer Eliassen Grini*

9:10-9:30

**“Don’t forget us!”. From warscape to memoryscape: the heritage of the First World War in Italy**

*Giovanni Azzalin; Luigi Magnini*

9:30-9:50

**Vandalism of the Spanish Civil War archaeological remains and heritage: the case of the Iron Belt (Basque Country)**

*Tania González Cantero*

9:50-10:10

**Representation of Memory through Commemoration in early historic site of Kanaganahalli, India (c. 1st century BCE-3rd century CE)**

*Debankita Das*

10:10-10:30

Discussion •





**SESSION 26. 'Three-dimensional Landscapes'. Current Applications on Survey, Analysis, and Visualization of Archaeological Landscapes**

CHAIRS: *Jorge Rouco Collazo; Alexis Maldonado Ruiz; Miguel Carrero Pazos*

8:30-8:50

**New Methods of Archaeological Documentation: Advancements in 3D Techniques at Cucuteni – Cetatuie (NE – Romania)**

*Radu Brunchi; Andrei Asăndulesei; Felix-Adrian Tencariu; Casandra Brasoveanu*

8:50-9:10

**Rediscovering Los Millares. 3D digitisation and spatial analysis with LiDAR of a Chalcolithic settlement in the south of the Iberian Peninsula**

*Alexis Maldonado Ruiz; Alberto Dorado Alejos; Juan Antonio Cámara Serrano; Fernando Molina González*

9:10-9:30

**Let's make the invisible visible. LiDAR investigations and archaeological data from fortified sites attributed to the Bronze Age in Eastern Romania**

*Diaconu Vasile; Gerea Alexandra; Tătaru Dragoș; Năstase Eduard; Grecu Bogdan; Zaharia Bogdan; Toma-Dănilă Dragoș; Mihai Elimian Andrei; Cerbu Bogdan*

9:30-9:50

**The Application of LiDAR based 3D models as an aid to the interpretation of Hillforts - a case study**

*Simon Maddison*

9:50-10:10

**Perception, Interpretation and Projection: Funerary Architecture as a node between Geographic Landscape and Solar Cycle. Geometry and balance in a dual system**

*María Dolores Joyanes Díaz; Carmen Muñoz González; Jaromir Krejčí*

10:10-10:30

**Discussion •**

10:30-11:30 h

**Coffee Break**

11 June **TUESDAY**

**ROOM 1**

**SESSION 7.** Computational Approaches in Landscape Archaeology: Exploring Human-Environment Dynamics and Settlement Patterns from Prehistory to Recent Times

CHAIRS: *Mikel Díaz-Rodríguez; Cristian Lorenzo-Salgueiro; Miguel Carrero-Pazos*

11:30-11:50

**Mountain routes. A landscape study of the Sierra Nevada.**

*Ylenia Paciotti; Anna Maria Stagno; José María Martín Civantos*

11:50-12:10

**Modelling Movement in the Desert – An Egyptian case study.**

*Rebecca Döhl*

12:10-12:30

**Mapping Harappan Navigation Routes: Fresh Insights from Remote Sensing-based Landscape Study.**

*Ekta Gupta; V. N. Prabhakar*

12:30-12:50

**Uncovering the ‘secrets’ of NE Romania’s burial mounds through high-resolution Airborne and Remote Sensing techniques.**

*Casandra Brasoveanu; Andrei Asăndulesei; Radu-Alexandru Brunchi*

12:50-13:10

**Discussion •**

**ROOM 2**

**SESSION 34.** Open Session

CHAIRS: *Scientific Committee*

11:30-11:50

**‘Between culture and nature’: the Archaeological Park of El Julan and the heritage potential of El Hierro, Canary Islands (Spain)**

*Gloria María Pérez Novillo*

11:50-12:10

**“From LiDAR to Legacy”: Mapping the Archaeological Landscape of the Topolog River Valley (Romania)**

*Mihai Stefan Florea; Andrei Asăndulesei; Corina Bor; Maria-Magdalena Ştefan; Călin Şuteu*



12:10-12:30

**Two worlds apart? Contested biocultural connections across the Icelandic and Sicilian landscape heritage**

*Pablo Barruezo-Vaquero; Árni Daníel Júlíusson; Gylfi Helgason; Rocco Corselli; Ragnhildur Sigurðardóttir; María Teresa Bonet García; José María Martín Civantos*

12:30-12:50

Discussion •

ROOM 3

**SESSION 5. Community in the mining landscape: analysing human-environment interactions through a multidisciplinary approach**

CHAIRS: *Luisa Dallai; Mauro Buonincontri*

11:30-11:50

**The transformations in northwest Iberia landscapes after the roman conquest: the impact of gold mining in the upper Sil river**

*Rubén Rubio Díez*

11:50-12:10

**How a medieval community shapes a mining landscape: the case of the Iglesias silver mountains in Sardinia**

*Nicolas Minvielle*

12:10-12:30

**Pre-industrial mining landscapes in the Colline Metallifere region (Tuscany, central Italy). A multiproxy study of environments and communities**

*Luisa Dallai; Giovanna Bianchi*

12:30-12:50

**Scars on the Landlord of Molina de Aragón: Medieval Mining Landscapes in the Center of the Iberian Peninsula through Archaeometallurgy and Spatial Analysis**

*Sergio Adamuz-Osuna; Yaiza Hernández-Casas; Mercedes Murillo Barroso; Guillermo García-Contreras Ruiz*

12:50-13:10

Discussion •

11 June **TUESDAY**

**ROOM 4**

**SESSION 12.** Exploring the interaction between humans and their environment: The Roman road network and associated structures through Landscape Archaeology

CHAIRS: *Miriam González Nieto and José Luis Domínguez Jiménez*

11:30-11:50

**Roman road network, centuriated landscape and settlement patterns in the Empordà plain (North-Eastern Catalonia): archaeomorphology and geoarchaeological research**

*Josep Maria Palet; Alfredo Mayoral; Isabel Mattuzzi; Arnau Carbonell; Arnau Garcia-Molsosa*

11:50-12:10

**The evolution of the archaeological landscape and the road network in the south of Roman Cantabria.**

*Alejandro Fernández-González; Jesús -Ignacio Jiménez-Chaparro; Carolina Cortés-Bárceña; Juan-José Cepeda-Ocampo; Alicia Ruiz-Gutiérrez*

12:10-12:30

**Roman road network around Primitiva Complutum: relationships between countryside and city.**

*Sandra Azcárraga Cámara; Arturo Ruiz Taboada; Enrique Capdevila Montes*

12:30-12:50

**Reassessing the Roman roads between Augusta Emerita and Olisipo: A remote sensing and GIS-based analysis for a proposed route in Alto Alentejo (Portugal).**

*Gil Vilarinho; Pedro Trapero Fernández; André Carneiro*

12:50-13:10

**Discussion •**

**ROOM 5**

**SESSION 20.** Ideology, production and social change. Forms of territorial organization during the 3rd to 1st centuries BCE

CHAIRS: *María Isabel Moreno Padilla; Susana González Reyero*

11:30-11:50

**New models of exploitation of a territory of the Upper Guadalquivir after the Second Punic War: The Ossigintania**

*Darío Garrido Almagro; Miguel Ángel Lechuga Chica*



11:50-12:10

**Territorial organization of the Southern Meseta between the 3rd and the 1st centuries BC: local responses and global processes**

*Susana González Reyero*

12:10-12:30

**Mapping the memory. Conflict, material culture, and territorial organization between the 3rd century BC and the 1st century AD in the Upper Guadalquivir**

*María Isabel Moreno; Carmen Rueda Galán*

12:30-12:50

**Castro societies during the Late Republican Iron Age: identities, relations of production and social change**

*Inés Sastre Prats; Brais X. Currás*

12:50-13:10

**Ups and downs. Diachronic survey of the social changes in Carpetania through landscape analysis between the fourth and the first centuries BC.**

*Pablo Sánchez de Oro*

ROOM 6

**SESSION 1. Farm, fold, shieling: environments, animal management and the transhumant systems in the North Atlantic región**

CHAIRS: *Oscar Aldred; Egill Erlendsson; Árni Daniél Júlíusson; Gylfi Helgason*

11:30-11:50

**Trans-human: human and nonhuman entanglements at shielings in Iceland**

*Oscar Aldred*

11:50-12:10

**Social implications of transhumance in Iceland: A landscape perspective**

*Gylfi Helgason*

12:10-12:30

**The historical development of summer farming in Iceland 900-1900 - comparing written and archaeological records.**

*Árni Daniél Júlíusson*

12:30-12:50

**Shielings and their surroundings: The palaeoenvironment of two shielings in Svarfaðardalur, N-Iceland**

*Snædís Thorlacius*

12:50-13:10

**Discussion •**

11 June **TUESDAY**

**ROOM 7**

**SESSION 9.** Mobility, settlements and Archaeology: How ancient movements have shaped the Landscape?

CHAIRS: *David Garcia-Casas; Thibault Sainenoy*

11:30-11:50

**Borders, routes, territoriality – late Bronze and Early Iron Age hoards in landscape. Polish examples**

*Marcin Maciejewski*

11:50-12:10

**A zooarchaeological approach into husbandry differences between riverside and hilltop settlements during the early Iron Age in the north Iberian Peninsula hinterland**

*Juan Antonio Antolinos-Díaz; Eneko Iriarte; Ignacio Ruiz Vélez; Marta Francés-Negro*

12:10-12:30

**Ancient Port Towns of Malabar Coastal Plain in India: From Manuscripts to Landscapes**

*Saravanan R saru*

12:30-13:10

**Discussion •**

**ROOM 8**

**SESSION 22.** Memoryscapes: Monuments, materiality, and the memorialisation of the landscape

CHAIRS: *Marianna Negro; Julia Gustafson*

11:30-11:50

**Materializing memories of a lost landscape: Lower Nubian monuments in the Sudan National Museum and their preservation amid war**

*Rennan Lemos*

11:50-12:10

**“Entheotopos”: Towards the structural elements of sacred landscape.**

*Antonio Muñoz Herrera*

12:10-12:30

**Moundsapes of Azerbaijan: Three Millennia of Evolving Burial Landscapes.**

*Stefania Fiori*



12:30-12:50

**Intervisibility studies applied to the Prehistoric funerary landscape of Menorca (Balearic Islands, Spain)**

*Sonia Carbonell Pastor*

12:50-13:10

Discussion •

ROOM 9

**SESSION 26. 'Three-dimensional Landscapes'. Current Applications on Survey, Analysis, and Visualization of Archaeological Landscapes**

CHAIRS: *Jorge Rouco Collazo; Alexis Maldonado Ruiz; Miguel Carrero Pazos*

11:30-11:50

**Landscape Archaeology in Morocco**

*Dirk Blaschta*

11:50-12:10

**A test for the integration of Micro-topographic reconstructions and Machine Learning-based image analysis for the characterization of archaeological surface record**

*Arnau García-Molsosa; Iban Berganzo-Besga; Merkouris Georgiadis; Eurydice Kefalidou; Nikolas Dimakis; Paraskevi Motsiou; Alfredo Mayoral; Isabel Mattuzzi; Constantina Kallintzi; Maria Chrysafi; Hector A. Orengo*

12:10-12:30

**MED.LAS (MEDiterranean Lidar Archaeological Survey): Unveiling Archaeological Landscapes: Integrating Drone and Lidar Technology in Forested and Mountainous Areas of the Mediterranean**

*Giuseppe Prospero Cirigliano*

12:30-12:50

**Fly Away. Multiscale digitisation and spatial analysis of the medieval castro of Doña Palla (Asturias)**

*Alexis Maldonado Ruiz; Miguel Busto Zapico; Francisco Lara Pinera; Matthias Biro-Sarrias; Carmen Sánchez Castillo; Salvador González Alvaz; Elena Lastra Alonso*

12:50-13:10

Discussion •

13:30-15:00

**Work Lunch & Break**

11 June **TUESDAY**

**ROOM 1**

**SESSION 7.** Computational Approaches in Landscape Archaeology: Exploring Human-Environment Dynamics and Settlement Patterns from Prehistory to Recent Times

CHAIRS: *Mikel Díaz-Rodríguez; Cristian Lorenzo-Salgueiro; Miguel Carrero-Pazos*

15:00-15:20

**Analysis of the intervisibility of archaeological sites in the Guadiato Valley: Implementation of Remote Sensing and Study of Visual Patterns in its Historical Landscape.**

*Francisco Javier Catalán González*

15:20-15:40

**Beyond the Surface: Remote Sensing Technologies Revolutionize Prehistoric Site Analysis in Southern Carpathian Basin.**

*Hrvoje Kalafatić; Rajna Šošić Klindžić; Bartul Šiljeg*

15:40-16:00

**A comprehensive study of ancient irrigation landscapes in the arid climate through the application of remote sensing and machine learning methods.**

*Nazarij Buławka; Hector A. Orengo*

16:00-16:20

**Long-term Settled Sites from the First Millennium AD. on the Morava River Basin – Predictive Modelling, Remote Sensing and Non-invasive Geophysics as a Tool of Research.**

*Marek Hladík; Katarína Hladíková; David Cibulka*

**ROOM 3**

**SESSION 5.** Community in the mining landscape: analysing human-environment interactions through a multidisciplinary approach

CHAIRS: *Luisa Dallai; Mauro Buonincontri*

15:00-15:20

**The Value of Waste: Archaeology of the Mining Landfills of Pre-industrial and Industrial Sardinia**

*Mattia Sanna Montanelli; Fabio Calogero Pinna*

15:20-15:40

**Tracing socio-ecological history of the North Karanpura Coal field, Jharkhand India**

*Amrita Slatch*

15:40-16:20

**Discussion •**





ROOM 4

**SESSION 12.** Exploring the interaction between humans and their environment: The Roman road network and associated structures through Landscape Archaeology

CHAIRS: *Miriam González Nieto and José Luis Domínguez Jiménez*

— 15:00-15:20

**Unravelling Roman Connectivity between the Strait of Gibraltar and the Western Baetic System.**

*María del Mar Castro García; Antonio Jesús Ortiz Villarejo; David Laguna Palma*

— 15:20-15:40

**The routes of Betic oil.**

*Eva Zarco Martínez*

— 15:40-16:20

Discussion •

ROOM 5

**SESSION 20.** Ideology, production and social change. Forms of territorial organization during the 3rd to 1st centuries BCE

CHAIRS: *María Isabel Moreno Padilla; Susana González Reyero*

— 15:00-15:40

Discussion •

ROOM 6

**SESSION 32.** Rock art and megalithic monuments as key elements to understand the Late Prehistory landscapes

CHAIRS: *Alia Vázquez Martínez; Esther Navajo Samaniego*

— 15:00-15:20

**Development-induced changes in megalithic landscapes and challenges of reconstructing prehistoric-Iron Age life. Investigations into the impact of dam construction on the megalithic remains in the Malampuzha reservoir region of Kerala, India**

*Rajan Koyu*

— 15:20-15:40

**Basaltic quarries as sources for megalithic monument construction: insights from the Menjez area (Akkar, Northern Lebanon)**

*Méryl Defours; Florian Cousseau; Tara Steimer-Herbet*

11 June **TUESDAY**

15:40-16:00

**Analysing territorial occupation through megalithic distribution in the middle Guadiana River basin**

*Esther Navajo Samaniego*

16:00-16:20

**Discussion •**

### ROOM 7

**SESSION 27. No-man's Land? Debating borders, boundaries, and frontiers as areas of interaction, connection, and exchange in Western Europe from the Chalcolithic to the Iron Age**

CHAIRS: *Pablo Sánchez de Oro*

15:00-15:20

**Fluctuating frontiers in the Late Iron Age Northern British borderlands**

*Manuel Fernández-Götz*

15:20-15:40

**The use of spatial clustering techniques to identify ancient socio-political territories: a case study of British hillforts**

*Simon Maddison*

15:40-16:00

**Borders and territoriality in Nuragic Sardinia: the case of Trexenta**

*Cezary Namirski*

16:00-16:20

**Unravelling limits between Past and Present in Carpetania**

*Pablo Sánchez de Oro*

16:20-16:40

**Discussion •**

### ROOM 8

**SESSION 22. Memoryscapes: Monuments, materiality, and the memorialisation of the landscape**

CHAIRS: *Marianna Negro; Julia Gustafson*

15:00-15:20

**Sardinian Landscapes of Memory: a view from the Giara di Siddi**

*Riley Glickman; Julia Gustafson*



15:20-15:40

**Five Millennia of Large Stones for the Dead. The Megalithic Phenomenon as Diachronic Feature in Funerary Architecture at La Peña de los Enamorados, Antequera, Spain.**

*Jose Ruiz Flores; Florian Cousseau; David Wheatley; José Antonio Lozano Rodriguez; Raquel Montero Artús; Alexia Dorkel; Myriam Ifriquia Bensaïd; Marie Besse; Leonardo García Sanjuán*

15:40-16:00

**Enduring Landscapes of the Passage Tomb Tradition in Western Europe: A Comparative Study of Newgrange, Maeshowe, and Gavrinis**

*Julia Gustafson*

16:00-16:20

**Discussion •**

ROOM 9

**SESSION 26. 'Three-dimensional Landscapes'. Current Applications on Survey, Analysis, and Visualization of Archaeological Landscapes**

*CHAIRS: Jorge Rouco Collazo; Alexis Maldonado Ruiz; Miguel Carrero Pazos*

15:00-15:20

**A multi-scale approach to the documentation of landscape through new technologies. The case of the Alpujarra (Almería and Granada, Spain)**

*Jorge Rouco Collazo*

15:20-15:40

**The bullet, the enclosure and the camera. Using new technologies for the study of the Spanish Civil War landscapes in northern Madrid**

*Alejandro González Trejo; Pablo Gutiérrez de León Juberías*

15:40-16:20

**Discussion •**

16:15-17:00

**Coffee Break**

11 June **TUESDAY**

**ROOM 1**

**SESSION 7.** Computational Approaches in Landscape Archaeology: Exploring Human-Environment Dynamics and Settlement Patterns from Prehistory to Recent Times

CHAIRS: *Mikel Díaz-Rodríguez; Cristian Lorenzo-Salgueiro; Miguel Carrero-Pazos*

17:00-17:20

**Exploring Socio-Political Dynamics in the Bronze Age North-East Peloponnese: A Computational Approach.**

*Boumpoulina Keramida*

17:20-17:40

**Agroecological Landscapes of Pergamon: Investigating Relations Between Natural Resources and Rural Settlements in the Environs of an Ancient City.**

*Robert Busch; Fabian Becker; Bernhard Ludwig; Brigitta Schütt*

17:40-18:00

**Exploring the automatised classification of pottery wares: towards a semantic segmentation of hyper-spectral images of Roman assemblages.**

*Daniel Ponsa; Arnau Garcia-Molsosa; Hector A. Orengo; Gerard Graugés; Pau Cano; Núria Romani; Gemma De Solà*

18:00-18:20

**Still, Mind the Gap! Bridging Theory and Practice in Settlement Pattern Computational Analysis.**

*Joan Negre*

18:20-18:40

**Discussion •**

**ROOM 6**

**SESSION 32.** Rock art and megalithic monuments as key elements to understand the Late Prehistory landscapes

CHAIRS: *Alia Vázquez Martínez; Esther Navajo Samaniego*

17:00-17:20

**The Relationship between Megalithic Monuments and Rock Art in Mosteirô, Ponte da Barca, North-West Portugal**

*Luciano Vilas Boas; Simon Peña; Ana Bettencourt.*



17:20-17:40

**Looking for answers: the radial archaeological survey of Minateda rock art site (SE Spain)**

*Alberto Mingo; Francisco Ramos; Luis Izquierdo; Valeria Francés; Alexis Armengol; Néstor Lozano-López.*

17:40-18:00

**Schematic Rock Art in the central Iberian Peninsula. La Sierra de Los Yébenes (Toledo) as territorial model**

*María del Carmen Ramírez.*

18:00-18:20

Discussion •

ROOM 8

**SESSION 22. Memoryscapes: Monuments, materiality, and the memorialisation of the landscape**

CHAIRS: *Marianna Negro; Julia Gustafson*

17:00-17:20

**Names of the Namib: land use and community-building in extreme arid environments**

*Kiah Johnson*

17:20-17:40

**UNESCO Global Geoparks-UGGp as Geological and Archaeological Culture Heritage Memoryscapes**

*Georgios Dimitriadis; Artur A. Sá*

17:40-18:00

Discussion •

12 June WEDNESDAY

**ROOM 1**

**SESSION 15.** Integrated approaches to heritage landscape studies

CHAIRS: *Kyle P. Hearn; Wouter Verschoof-van der Vaart*

8:30-8:50

**Cultural heritage as medium and outcome. Citizen science and the role of the expert**

*Guillermo Reher*

8:50-9:10

**Value of Find Spots in Understanding Heritage Landscapes in Estonia**

*Greta-Krislin Lutter; Helena Kaldre*

9:10-9:30

**Challenges and opportunities of heritage conflicts: the World Heritage landscape of Las Médulas (Spain)**

*Nekbet Corpas*

9:30-9:50

**Maritime landscapes of Rocha, Uruguay: first approach to the underwater cultural heritage of Cabo Polonio and La Paloma**

*Elena Saccone*

9:50-10:10

**Agricultural archaeology and heritage education as tools for rural development**

*Paloma Sánchez-Broch; José Alberto Delgado Arcos; Santiago Rodríguez-Pérez; Pablo López Gómez; Margarita Fernández Mier; Andrés Menéndez Blanco; Elías Carballido González*

10:10-10:30

**Discussion •**

**ROOM 2**

**SESSION 11.** Challenging landscapes and hunter-gatherers' subsistence and mobility

CHAIRS: *Mae Goder-Goldberger; Michal Birkenfeld; Laura Sánchez-Romero*

8:30-8:50

**Evidence for hominin activity in the Be'eri Badlands (Israel): Preliminary geo-archaeological results**

*Gadi Herzlinger; Nira Alperson-Afil; Onn Crouvi; Rivka Rabinovitch*



8:50-9:10

**Local resource management at Abri du Maras from MIS7 till MIS 3**

*Ana Abrunhosa; M. Gema Chacón; Marie-Hélène Moncel*

9:10-9:30

**The raw materials catchment in the northwest zone of Sierra Morena during the Middle Paleolithic: The Sima Cave (Constantina, Seville) and their quartz exploitation**

*Marta Cañete-Gómez; José Antonio Caro-Gómez; Genaro Álvarez-García; César Borja Barrera; Eusebio Jesús Medina-Luque; Juan Manuel Garrido-Anguita; Mateo Korots-Krasnova; José Manuel Recio-Espejo*

9:30-9:50

**Revisiting the Middle Palaeolithic in the Nile Valley: new insights from the western low desert, Thebes**

*Emily Hallinan; Judith Bunbury; Giulio Lucarini; Lorena Lombardi; Alessia Brucato; Piers Litherland*

9:50-10:10

**Far'ah II, a late Middle Paleolithic site in the Northwestern Negev, Israel: Revisiting the 1976-78 excavations.**

*Mae Goder-Goldberger; Laura Sánchez-Romero; Liora Kolska Horwitz*

10:10-10:30

**Discussion •**

**ROOM 3**

**SESSION 10. Archaeology of the Uplands: searching for models and methodology in high altitude human-shaped landscapes**

CHAIRS: *Cristiano Putzolu; Federico Zoni*

8:30-8:50

**An innovative approach to the mapping, characterisation, and dating of Hong Kong's terraced upland landscapes**

*Mick Atha; Sam Turner; Tim Kinnaird*

8:50-9:10

**The Emilian Apennines in the 2nd millennium BC: new perspectives on the settlement pattern.**

*Cristiano Putzolu; Jorge Calvelo Alvarez; Silvia Fiorini; Erik Zanotti; Claudio Cavazzuti*

9:10-9:30

**"What are [humans] to rocks and mountains?" Some self-reflective notes about archaeological practice in mountainous and upland landscapes.**

*Francesca Chelazzi; Kristen Hopper*

12 June WEDNESDAY

9:30-9:50

**Testing survey strategies in marginal and remote areas in the Apennine uplands. The case of the MoLuLaP project.**

*Martina Bernardi; Margherita Bottoni; Emeri Farinetti; Matteo Rossi*

9:50-10:10

**An analysis protocol for mountain areas and rock structures: preliminary results on post-medieval landscapes in the Underlandscape project.**

*Letizia Chiti; Marco Serradimigni; Antonio Alberti; Monica Baldassari; Enrica Salvatori; Maria Grazia Deri; Augusto Ciuffoletti; Vincenzo Palleschi; Enrica Lemmi*

10:10-10:30

**Discussion •**

#### ROOM 4

### SESSION 2. Surveying through changing landscapes

CHAIRS: *Miguel Almeida*

8:30-8:50

**Looking for new lakeside settlements. Geomorphological and paleoenvironmental reconstruction of the western shore of Lake Banyoles (NE Iberia).**

*Carlos Sánchez-Gacía; Jordi Revelles; Antoni Palomo; Raquel Piqué; Xavier Terrades*

8:50-9:10

**Human Occupation: analysis of archaeological sites in western Algarve through GIS**

*Daniela Maio; João Cascalheira; Célia Maria Gonçalves; Nuno Bicho; Luís Rodrigues; Sara Mira*

9:10-9:30

**The Dacian fortress of Ardeu (Hunedoara County, Romania) between archaeological landscape and landscape archeology**

*Dorel Micle; Iosif Vasile Ferencz; Alexandru Hegyi; Andrei Stăvilă*

9:30-9:50

**Archaeological surveying isn't skin deep**

*Miguel Almeida; Thierry Aubry; Luís Luís; Marcelo Silvestre; André Ferreira; Nuno Ramos*

9:50-10:10

**En route to a pollinic framework of the Côa Valley: state-of-the-art and perspectives**

*Patricia Ramos*

10:10-10:30

**Discussion •**





ROOM 5

**SESSION 17.** Bridging historical landscape ecology and landscape archaeology: common questions and challenges in a rapidly changing world

CHAIRS: *Sjoerd Kluiving; Alexandre Martinez; Rebekka Annie Paul Dossche; Benny Qihao Shen; Valentina Pescini; Pille Tomson; Nik Petek-Sargeant; Paul Lane*

8:30-8:50

**TerraNova: Natural ecological baseline evolution from deep history to the present** *inform* the urgency of current and future landscape management  
*Sjoerd Kluiving et al.*

8:50-9:10

**Identifying major phases in land use and changing landscapes by Agrarian Societies (7000 cal BP-Present) in Cantabrian Spain, based on cultural changes and anthropogenic signals**

*Alexandre Martinez; Anhelina Zapolska; Frank Arthur; Philip Verhagen; Sjoerd Kluiving; José Muñoz-Rojas; César Borja Barrera*

9:10-9:30

**Integrating historical, pedological and archaeological methods for forest habitat protection**

*Pille Tomson*

9:30-9:50

**Reshaping Landscapes: how to unravel the threads of prehistoric landscape transformation**

*Natalia Riabogina; Ralph Fyfe; Jelena Bulatovic; Elisabetta Canteri*

9:50-10:10

**Applications of Landscape Archaeology and Landscape Ecology in inland Sicily during the last two millennia**

*Angelo Castrorao Barba; Giuseppe Bazan*

10:10-10:30

**Discussion •**

ROOM 6

**SESSION 18.** Landscapes of equality: Decentralization, complexity and resistance in the political construction of space

CHAIRS: *Jordi A. López Lillo; Pablo Gutiérrez de León Juberías; Brais X. Currás Refojos; Inés Sastre Prats*

8:30-8:50

**Committing to heath: Living in Northern Europe's ancestral commons**

*Mette Løvschal; Mark Haughton*

12 June WEDNESDAY

8:50-9:10

**Reasserting equality: social strategies for the formation and replication of a decentralized landscape in castro societies.**

*Brais Xosé Currás Refojos; Inés Sastre Prats; Santiago Tuñas-Corzón.*

9:10-9:30

**A Water Management System in Iran: Questions of Infrastructural Ownership and Conflicts.**

*Fabian Sarga*

9:30-9:50

**Do we make the road or do the road makes us? A revision of the Acobamba-Ulcumayo road section (Junin, Perú).**

*Natalia Andrea Cisneros del Río.*

9:50-10:10

**Structured spaces, structuring egalitarianism, and the first villager landscapes of Southern Andes: The case of Tafí tradition (Northwest Argentina).**

*Jordi A. López Lillo; Ignasi Grau Mira; Valeria L Franco Salvi. Julián Salazar.*

10:10-10:30

**Discussion •**

## ROOM 7

**SESSION 14.** Questioning ruins, defining townscapes. late roman urban centers at the sight of new, high-resolution, integrated archaeological methods and theories

CHAIRS: *Mario Gutiérrez Rodríguez; Pilar Diarte-Blasco; Manuel Castro-Priego*

8:30-8:50

**Kilns, rubbish dumps and forums: on the heterogeneity of the early medieval city as a reflection of new relations of production**

*Jaime Sastre-Jiménez*

8:50-9:10

**Archaeological Architectural Space Research on the Urban Center Bathhouse of Lugdunum in the Early Roman Empire**

*Mei Yang; Zhiwei Ji*

9:10-9:30

**The role of waste management in the shaping of townscapes and urban biographies during Late Antiquity: a multiproxy microstratigraphic approach**

*Mario Gutiérrez Rodríguez*



9:30-9:50

**The Space In-between: Environmental transformation of the Eastern Caelian Quarter in Rome from the Late Antique to Early Medieval Period**

*Phyllida Bailey*

9:50-10:30

**Discussion •**

ROOM 8

**SESSION 25. Historical responses to environmental change: rethinking riverine-coastal landscape archaeology through interdisciplinary approaches**

*CHAIRS: Isabel Rondán; M. Juana López-Medina; Lázaro Lagostena-Barrios; Enrique Aragón, Alexandra Bivolaru*

8:30-8:50

**The AQVIVERGIA project and its advances in the historical study of river basins: Hasta Regia - Lacus Ligustinus and Urci - Lower Andarax**

*Lázaro Lagostena; María Juana López Medina*

8:50-9:10

**Human adaptation to environmental change: a case study from the central Netherlands showing a multi-proxy geo-archaeological record of 10.000 years of riverine-coastal landscape development.**

*Jos De Moor; Wilko van Zijverden; Timo Vanderhoeven; Eva Kars*

9:10-9:30

**The Testerep project: using archaeological, historical, and geological data to reconstruct 5000 years of human-environment interaction.**

*Zoë Vanbiervliet*

9:30-9:50

**3D Modelling of a fluvial Paleochannel associated with Prehistoric sites in Mato Miranda, Golegã – Portugal.**

*Vanessa Antunes; Silvério Figueiredo; Pedro Cunha; Hugo Gomes*

9:50-10:10

**Life-threatening choices. Investigating the Human-environment relationship of Ne Romania's Late Bronze Age.**

*Casandra Brasoveanu; Andrei Asăndulesei; Alin Mihu-Pintilie; Radu-Alexandru Brunchi*

12 June WEDNESDAY

8:30-10:30 h

10:10-10:30

**MidHolocene coastal Landscapes and Neolithic evolution of the Oman by a multi-scalar and multi-proxy study of in-site and off-site archives**

*Jean Francois Berger; Jérôme Lejot; Adrien Barra; Sebastián Pérez Díaz, José Antonio López Sáez; Caroline Mougne; Anais Marast; Philippe Bearez; Renato Nisbert; Melanie Montalti; Valentina Azzara; Alex de Rorre; Raphaelae Berger Guilbert; Guillaume Bruniaux*

10:30-10:50

**Discussion •**

## ROOM 9

**SESSION 29.** An evolving landscape. An analysis of the Iberian relationship between built space and material culture (4th-11th centuries)

CHAIRS: *Silvia Berrica; Celtia Rodríguez González*

8:30-8:50

**From villa to village: early medieval settlement patterns and domestic architecture in central and northwestern Iberia**

*Carlos Tejerizo*

8:50-9:10

**Domestic space and the scale of the everyday. An analysis from a gender perspective.**

*Celtia Rodríguez-González*

9:10-9:30

**Landscapes on the move: Emerging Perspectives in the Study of Early Medieval People and Space**

*Julio Escalona Monge*

9:30-9:50

**Niches construction and the evolution of Late Roman settlement in the Lower Guadalquivir basin (SW Spain)**

*Luis-Gethsemaní Pérez-Aguilar*

9:50-10:10

**The Agrarianization in the Late Periods of Eastern al Andalus: The Huerta of Ontinyent (València) before the 13th Century**

*Miguel Robledillo Sais*

10:10-10:30

**Discussion•**



10:30-11:30

**Coffee Break**

11:30-13:30 h

**ROOM 1**

**SESSION 15. Integrated approaches to heritage landscape studies**

CHAIRS: *Kyle P. Hearn; Wouter Verschoof-van der Vaart*

11:30-11:50

**Values of the Archaeological Heritage Landscape in Sweden**

*Matthew Nelson*

11:50-12:10

**The characterisation and future sustainability of a rural landscape: using integrated approaches for temporal heritage landscape analysis in NW Spain**

*Kyle P. Hearn*

12:10-12:30

**The Danger of a Single-sided Archaeology: Viewing (Pan)Kofyar through Ethnoarchaeological Lenses**

*Na'ankwat Kwapnoe-Dakup*

12:30-12:50

**Culture, nature or beyond? Integrated landscape studies from an archaeological and anthropogeomorphological perspective. Lednica Landscape Park (Poland) case study.**

*Lidia Żuk; Agnieszka Latocha-Wites*

12:50-13:10

**Discussion •**

**ROOM 2**

**SESSION 11.** Challenging landscapes and hunter-gatherers' subsistence and mobility

CHAIRS: *Mae Goder-Goldberger; Michal Birkenfeld; Laura Sánchez-Romero*

11:30-11:50

**Availability of flint and water in dry sandstone canyons: Paleolithic investigations in the western Hisma Basin, southern Jordan**

*Seiji Kadowaki; Kazunobu Ikeya; Yasuhisa Kondo; Kazuhiro Tsukada; Masato Hirose; Eiki Suga; Oday Tarawneh*

11:50-12:10

**How to live the high life – Contextualizing Late Pleistocene human occupations of the Afroalpine (Bale Mountains, Ethiopia)**

*Götz Ossendorf; Minassie Girma Tekelemariam*

12:10-12:30

**Animal and human use of landscapes and resource availability in Late Pleistocene Mongolia and the Altai Region**

*Arina Khatsenovich; Irina Vishnevskaya; Evgeny P. Rybin; Alexei Klementiev; Igor Chechushkov; Ksenia Kolobova; Dashzeveg Bazargur; Byambaa Gunchinsuren; John W. Olsen*

12:30-12:50

**Living along the big river: landscape use, settlement and mobility patterns during the Initial Upper Paleolithic of Transbaikal and northern Mongolia**

*Evgeny P. Rybin; Arina M. Khatsenovich; Yulia Antonova; Vasilij Tashak; Daria Marchenko; Dmitry Kobylkin; Byambaa Gunchinsuren*

12:50-13:10

**Discussion •**

**ROOM 3**

**SESSION 10.** Archaeology of the Uplands: searching for models and methodology in high altitude human-shaped landscapes

CHAIRS: *Cristiano Putzolu; Federico Zoni*

11:30-11:50

**The language of living mountains: livestock settlements and occupation dynamics in the Puigpedrós massif, Duran, Vallcivera and Llosa valleys (eastern Pyrenees, Spain).**

*Arnau Carbonell; Lúdia Colominas; Valentina Pescini; Alfredo Mayoral; Abel Gallego-Valle; Jesús Martínez; Hector A. Orengo*



11:50-12:10

**“There are Prehistoric cities up there”.** Methodological insights on fortified hilltop sites in southern Albania.

*Federica Carbotti*

12:10-12:30

**Sacred Landscapes: Cairns in Hills and Highlands of Uruguay**

*Maira Sotelo; Camila Gianotti*

12:30-12:50

**Architecture in and on the mountains: adaptation and innovation of the historic built environment.**

*Federica Matteoni; Chiara Pupella*

12:50-13:10

**Discussion •**

ROOM 4

## **SESSION 2.** Surveying through changing landscapes

CHAIRS: *Miguel Almeida*

11:30-11:50

**Exploring prehistoric waterscape in Maremma district (Central Italy): a focus on archaeological survey in the Talamone area**

*Giovanna Pizziolo; Gaia Mustone*

11:50-12:10

**A Roman spa under time: archaeological research on topographical changes, reoccupation and the increasing anthropization around a mineral spring (Termas de São Vicente, Penafiel, Portugal)**

*Silvia González Soutelo; André Ferreira; Nuno Ramos; Teresa Soeiro; Manuel Sá; Miguel Almeida*

12:10-12:30

**A mining landscape crossed by water: the hydraulic network of Las Médulas and the construction of the cultural landscape (León, Spain)**

*Almudena Orejas; Javier Sánchez-Palencia; Brais X. Currás; Juan Luis Pecharromán; Sebastián Pérez-Díaz*

12:30-13:10

**Discussion •**

12 June WEDNESDAY

**ROOM 5**

**SESSION 17.** Bridging historical landscape ecology and landscape archaeology: common questions and challenges in a rapidly changing world

CHAIRS: *Sjoerd Kluiving; Alexandre Martinez; Rebekka Annie Paul Dossche; Benny Qihao Shen; Valentina Pescini; Pille Tomson; Nik Petek-Sargeant; Paul Lane*

11:30-11:50

**A country-level assessment of long-term grassland changes since the 18th century in Hungary**

*Marianna Biró; Kinga Öllerer; László Demeter; János Bölöni; Zsolt Molnár*

11:50-12:10

**The historical landscape of north-western Asturias (Spain) and its recent transformations: cultural heritage as a resource for the future**

*Santiago Rodríguez-Pérez*

12:10-12:30

**How to capture landscape pathways? Combining insights from historical maps, aerial imagery and oral history as a mixed-method approach**

*Rebekka Dossche; Franziska Mohr*

12:30-12:50

**Designing the Historical Ecology of Beekeeping in the Central Rift Valley of Kenya**

*Benny Shen*

12:50-13:10

**Discussion •**

**ROOM 6**

**SESSION 18.** Landscapes of equality: Decentralization, complexity and resistance in the political construction of space

CHAIRS: *Jordi A. López Lillo; Pablo Gutiérrez de León Juberías; Brais X. Currás Refojos; Inés Sastre Prats*

11:30-11:50

**Duel of Landscapes. Centrifugal vs Centripetal landscapes. Visions from the Horn of Africa.**

*Pablo Gutiérrez de León Juberías*

11:50-12:10

**Landscapes of coexistence? The conformation of rural landscape in al-Andalus between local societies and State. The case of the Alpujarra (Granada and Almeria, Spain).**

*Jorge Roucao Collazo*





12:10-12:30

**Landscapes of Freedom: How Oppressed African American Communities in 19th Century Pennsylvania (USA) Deployed Landscape to Undermine Slavery and Promote Self Sufficiency.**

*Benjamin Carter*

12:30-13:10

Discussion •

ROOM 7

**SESSION 14.** Questioning ruins, defining townscapes. late roman urban centers at the sight of new, high-resolution, integrated archaeological methods and theories

CHAIRS: *Mario Gutiérrez Rodríguez; Pilar Diarte-Blasco; Manuel Castro-Priego*

11:30-11:50

**Flaviaugusta, a Roman settlement on the banks of the Homino River**

*Esperanza Martín Hernández*

11:50-12:10

**An approach to studies on chemical residues applied to Late Antique and medieval ceramics and their relationship with urban contexts**

*Mar Gallego-García; Pilar Diarte-Blasco; Manuel Castro-Priego*

12:10-12:50

Discussion •

ROOM 8

**SESSION 25.** Historical responses to environmental change: rethinking riverine-coastal landscape archaeology through interdisciplinary approaches

CHAIRS: *Isabel Rondán; M. Juana López-Medina; Lázaro Lagostena-Barrios, Enrique Aragón, Alexandra Bivolaru*

11:30-11:50

**Ecological Vulnerability and Human Responses in a GIS-based model of Surame, lower catchment of the Sokoto-Rima basin, Nigeria**

*Aliyu Adamu Isa*

11:50-12:10

**An integrated remote sensing approach to palaeogeographic and landscape changes around the ancient Greek colony of Abdera in coastal Thrace (Northern Greece)**

*Pau Canudas Grabolosa; Alfredo Mayoral; Arnau Garcia-Molsosa*

## 10-14 JUNE. ALCALÁ UNIVERSITY. SPAIN

### HUMAN CHALLENGES IN A CONTEXT OF CHANGING LANDSCAPES

12 June WEDNESDAY

11:30-13:30 h

12:10-12:30

**Developing interdisciplinary and integrated landscape archaeology approaches in the Aegean: current state and perspectives of archaeological, geoarchaeological and palaeoenvironmental research around Abdera (Thrace, Greece)**

*Alfredo Mayoral; Arnau Garcia-Molsosa; Mercourios Georgiadis; Ana Ejarque; Isabel Mattuzzi; Constantina Kallintzi; Maria Chrysafi; Hector A. Orengo; Josep Maria Palet*

12:30-13:10

**Discussion •**

#### ROOM 9

**SESSION 29. An evolving landscape. An analysis of the Iberian relationship between built space and material culture (4th-11th centuries)**

CHAIRS: *Silvia Berrica; Celtia Rodríguez González*

11:30-11:50

**Evolution of the territorial occupation in Islamic Elche and its surroundings. Interaction and evolution of the built spaces (8th - 11th centuries)**

*Raquel Bujalance Silva*

11:50-12:10

**Making Visible al-Andalus. The Transformation of landscape between the 9th-11th centuries.**

*Silvia Berrica*

12:10-12:30

**Landscapes of production and consumption in the southeast of the iberian peninsula in the early middle ages**

*Victoria Amoros Ruiz*

12:30-12:50

**Decolonizing landscapes, a transcultural approach.**

*Lauro Olmo-Enciso*

12:50-13:10

**Unlocking Atienza's landscapes: Material culture and a settlement patterns in the central frontier of al-Andalus (8th.-11th c.).**

*Guillermo García-Contreras; Luca Mattei; Emilio Cano Padilla; David Rodríguez Sánchez; Sergio Adamuz; Yaiza Hernández-Casas; Marcos García García; Rowena Y. Banerjee; Michelle Alexander; Aleks G. Pluskowski;*

13:10-13:30

**Discussion •**



13:30-15:00

**Work Lunch & Break**

**ROOM 1**

**SESSION 15.** Integrated approaches to heritage landscape studies

CHAIRS: *Kyle P. Hearn; Wouter Verschoof-van der Vaart*

15:00-15:20

**Early medieval settlement cluster at Ciepłe (Northern Poland). Human – environment interactions and land use dynamics**

*Weronika Bałdyga; Sławomir Wadył*

15:20-15:40

**Landscape impact assessment of Sukur cultural landscape, northeast Nigeria**

*Akinbowale Akintayo*

15:40-16:00

**Heritage Quest: A two-tier citizen science research project analysing LiDAR data from the central Netherlands**

*Wouter Verschoof-van der Vaart; Eva Kaptijn; Karsten Lambers; Quentin Bourgeois*

16:00-16:20

**Discussion •**

**ROOM 2**

**SESSION 11.** Challenging landscapes and hunter-gatherers' subsistence and mobility

CHAIRS: *Mae Goder-Goldberger; Michal Birkenfeld; Laura Sánchez-Romero*

15:00-15:20

**Upper Paleolithic blank cutting edge efficiency within the Tolbor Valley, Mongolia: an eastern steppe landscape**

*Corey L. Johnson; Tsedendorj Bolorbat; Mark N. Grote; Clea H. Paine; Guunii Lkhundev; Davaakhuu Odsuren; Arina M. Khatsenovich; Masami Izuho; Byambaa Gunchinsuren; Nicolas Zwyns, Evgeny P. Rybin*

15:20-15:40

**Desert Dynamics: Neolithic Hunter-Gatherers of the Negev Desert**

*Michal Birkenfeld*

12 June WEDNESDAY

15:40-16:00

**Bilma- a menu for the Central Sahara. Present-day and Late Pleistocene/ Holocene food resources and food strategies.**

*Erhard Schulz; Aboubacar Adamou*

16:00-16:20

**Discussion •**

### ROOM 3

**SESSION 10.** Archaeology of the Uplands: searching for models and methodology in high altitude human-shaped landscapes

CHAIRS: *Cristiano Putzolu; Federico Zoni*

15:00-15:20

**The Method of Archaeological Analysis of Architecture applied to Rural and Mountain Contexts. The case of Seppiana.**

*Chiara Ribolla*

15:20-15:40

**A place for gods and men: Tor dei Pagà (Vione, Valcamonica - Italy).**

*Giovanna Bellandi; Alessandro Bona; Chiara Bozzi; Deneb Cesana; Delia Fanetti;*

*Riccardo Valente*

15:40-16:20

**Discussion •**

### ROOM 5

**SESSION 17.** Bridging historical landscape ecology and landscape archaeology: common questions and challenges in a rapidly changing world

CHAIRS: *Sjoerd Kluiving; Alexandre Martinez; Rebekka Annie Paul Dossche; Benny Qihao Shen; Valentina Pescini; Pille Tomson; Nik Petek-Sargeant; Paul Lane*

15:00-15:20

**Merging archaeology and ecology in studies of extensive pastoral systems in Sweden. Further concerns for heritage management in a rapidly changing world.**

*Ingrid Sarlöv-Herlin; Graham Fairclough*

15:20-15:40

**Applied historical ecologies in Kenya: What to do with 200-years of human-environment interaction?**

*Nik Petek-Sargeant*



15:40-16:00

**Exploring Historical Biocultural Diversity in Urban Landscapes as a Baseline for Rebuilding Habitat Connectivity**

*Simay Kirca*

16:00-16:20

**Towards a Comprehensive Theory of the Anthropocene**

*Sjoerd Kluiving*

16:20-16:40

**Discussion •**

ROOM 6

**SESSION 21. Crisis? What crisis? New perspectives on the crisis of the Late Roman Empire**

CHAIRS: *Josu Narbarte; Oriol Olesti; Eneko Iriarte*

15:00-15:20

**When dams flooded out of sediment: sedimentary silting of the Roman Mues dam (Navarre, Spain)**

*Eneko Iriarte; Josu Narbarte*

15:20-15:40

**Crisis? Decrease? Post-boom?! Climate, floods, and erosion in Roman Imperial Pergamon (western Türkiye) from the 2nd to the 4th century C.E.**

*Fabian Becker; Robert Busch; Mehmet Doğan; Ulrich Mania; Wolf-Rüdiger Teegen; Felix Pirson; Brigitta Schütt*

15:40-16:00

**Flooded landscapes: geoarchaeological investigations on the Late Roman landscape transformations in the middle Ebro valley (Iberian Peninsula)**

*Josu Narbarte; Mattin Aiestaran de la Sotilla; Oihane Mendizabal Sandoñis; Eneko Iriarte; Manex Arrastoa Mendizabal*

16:00-16:20

**Which relation between agriculture, settlement, and climate in central-northern Portugal during the Late Roman Empire**

*João Tereso; Luís Seabra; Catarina Magalhães; Sofia Lacerda; Pedro C. Carvalho*

16:20-16:40

**Discussion •**

12 June WEDNESDAY

**ROOM 7**

**SESSION 24.** Lost in the landscape. Abandoned Towns between Late Antiquity and the Middle Ages in the Mediterranean Area

CHAIRS: *Marta Pérez-Polo*

15:00-15:20

**Urban and rural contexts as landscape entities: an analysis of the peninsular centre from an integrative perspective (5th-7th century)**

*Isabel Fernández Urbina; Pilar Diarte-Blasco; Manuel Castro-Priego*

15:20-15:40

**Lost landscapes or invisible landscapes in the Iberian Peninsula? Tarazona and its territory during the Late Antiquity and Early Middle Ages**

*Marta Pérez-Polo*

15:40-16:00

**Fall and Rise. The Endurance and Decline of Tarragona after the Islamic Conquest of the Iberian Peninsula**

*Joan Negre; Ada Lasheras; Francesc Rodríguez*

16:00-16:20

**Finding Banzos. Preliminary results on the research of an abandoned village in the northern Sardinia**

*Luca Caloi; Stefano Pedersoli; Giulio Sciarroni; Francesco Cuccuru; Marco Milanese*

16:20-16:40

**Discussion •**

**ROOM 8**

**SESSION 25.** Historical responses to environmental change: rethinking riverine-coastal landscape archaeology through interdisciplinary approaches

CHAIRS: *Isabel Rondán; M. Juana López-Medina; Lázaro Lagostena-Barrios; Enrique Aragón, Alexandra Bivolaru*

15:00-15:20

**Ports of the East, ports of the West: Comparative approaches to Roman ports, mobility and connectivity in the Mediterranean**

*Maria del Carmen Moreno Escobar*

15:20-15:40

**Legal security for human-river interaction in the framework of changing riparian landscapes: the river islands**

*José Luis Cañizar Palacios*



PARALLEL SESSIONS

12 June WEDNESDAY

15:00-16:20 h

15:40-16:00

**Discussion •**

16:15-17:00

**Coffee Break**

PARALLEL SESSIONS

12 June WEDNESDAY

17:00-18:40 h

**ROOM 1**

**SESSION 15.** Integrated approaches to heritage landscape studies

CHAIRS: *Kyle P. Hearn; Wouter Verschoof-van der Vaart*

17:00-17:20

**Safeguarding heritage in the outer plains of Jammu: A synergistic endeavour between academia and non-academic communities**

*Navjot Kour; Francesc Conesa; Arnau Garcia-Molsosa; Hector A. Orengo*

17:20-17:40

**Ecological and Cultural Significance of Traditional Groundwater Harvesting in Sand Agroecosystems in Mediterranean and Adjacent Regions**

*Ruben Sanchez; Joel Roskin*

17:40-18:00

**Enhancing Mountain Cultural Landscapes as a resource for sustainable territorial development: transfer knowledge through Cultur-Monts European project (Interreg Sudoe)**

*Josep Maria Palet; Marta Flórez; Lúdia Colominas; Valentina Pescini; Arnau Carbonell; Paloma Aliende; Alfredo Mayoral*

18:00-18:20

**Combining historical aerial photography, cartography and satellite-based data for the detection of sites and archaeological features in the Kambos area (Thessaly, Greece)**

*Konstantina Venieri; Athanasia Krachtoglou; Arnau Garcia-Molsosa; Giannis Apostolu; Hector A. Orengo; Anastasia Dimoula; Niki Saridaki; Evangelia Vliora; Nikolas Dimakis*

18:20-18:40

**Discussion •**

12 June WEDNESDAY

17:00-18:40 h

**ROOM 6**

**SESSION 21. Crisis? What crisis? New perspectives on the crisis of the Late Roman Empire**

CHAIRS: *Josu Narbarte; Oriol Olesti; Eneko Iriarte*

17:00-17:20

**Consequences of and responses to hydrosedimentary crisis during Roman period in the upper Rhône valley: case study of the Vernai villa (Isère, France)**

*Vermot Lia; berger jean-francois; Royet Robert; Argant Jacqueline*

17:20-17:40

**Changing mountains. Late Roman settlement, water management and land-use dynamics reconstructed through the geoarchaeological analysis of the archaeosedimentary archives of Artzi (Navarre, Western Pyrenees)**

*Oihane Mendizabal Sandonís; Josu Narbarte; Mattin Aiestaran de la Sotilla; Eneko Iriarte*

17:40-18:00

**The Roma colony of Ilici (Elx, Alacant). Centuriation and resilience.**

*Oriol Olesti Vila*

18:00-18:20

**New perspectives on Ager Tarraconensis: the Late Antique rural landscape.**

*Jose Maria Carrasco López; Adrià Cubo Córdoba; Jordi Morera Camprubí; Josu Narbarte Hernández; Oriol Olesti Vila*

18:20-18:40

**Discussion •**





ROOM 1

**SESSION 3.** Ecology and archaeology of forest land use legacies: charcoal analysis as analytical tools of human-induced changes

CHAIRS: *Mauro Buonincontri; Claudia Speciale; Bàrbara Mas*

8:30-8:50

**Fire is a tool. Slash and burn, flaming and the fate of the charred material.**

*Erhard Schulz; Ludger Herrmann; Attila Bencsik; Horea Cacovean; Bohdan Prots; Mathias Hall*

8:50-9:10

**An approach from charcoal analysis in geoarchaeological records to holocene vegetation dynamics in the semiarid lands of the central Ebro basin (NE Spain)**

*Marta Alcolea; José L. Peña-Monné; María M. Sampietro-Vattuone; Jesús Picazo*

9:10-9:30

**Exploitation of wood and its environmental context during Roman times in western Iberia**

*João Tereso, et al.*

9:30-9:50

**The exploitation of forest environment at the Roman site of Sepino (Molise, Italy): the role of anthracological analyses.**

*Arianna Sellitto; Girolamo Fiorentino*

9:50-10:30

Discussion •

ROOM 2

**SESSION 8.** What are you doing here?

CHAIRS: *Marta Francés-Negro; Izaro Quevedo-Semperena*

8:30-8:50

**Origins of siliceous rocks exploited at Peña Capón (central Spain) and its relevance for understanding large social networks in Southwest Europe during the Solutrean.**

*Manuel Alcaraz-Castaño; Marta Sánchez de la Torre; Xavier Mangado; Samuel Castillo-Jiménez; Thierry Aubry; Luis Luque; Felipe Cuartero; Richard Hewitt; Miguel Almeida; Javier Alcolea-González; Bernard Gratuze*

8:50-9:10

**Raw material procurement strategies of a quartz-based assemblage: the case of Navalmaíllo Rock Shelter.**

*Ana Abrunhosa; Belén Márquez Mora; Enrique Baquedano; Juan Luis Arsuaga; Alfredo Pérez-González*

13 June THURSDAY

9:10-9:30

**Clays and soils for a new city: raw material catchment areas in Punic Qart-Hadasht (South-Eastern Iberia).**

*Benjamín Cutillas-Victoria; Miguel Martín Camino; Sebastián F. Ramallo Asensio.*

9:30-9:50

**Exploring lithic raw materials: a multi-proxy methodological study.**

*Ana Álvarez-Fernández; Ana Isabel Casado; Laura Rodríguez; Belén Márquez Mora; Juan Luis Arsuaga; Rebeca García González.*

9:50-10:10

**Disclosing the origin of sparry calcite temper in protohistoric ceramics through stable isotope analysis**

*Eneko Iriarte; Marta Francés-Negro; Amalia Pérez-Romero; María Álvarez; Ángel Carrancho.*

10:10-10:30

**Discussion •**

### ROOM 3

**SESSION 16.** Landscapes of Desertions. Social memories, political practices and identities in a long-term perspective

CHAIRS: *Lukáš Holata; Carlos Tejerizo-García*

8:30-8:50

**Memories of the landscape. Visions through materiality**

*Antonio Chaín Galán; Daniel Méndez García; Francisco Rodríguez Plaza; César Gonzalo Cabrerizo*

8:50-9:10

**Eventual rural landscapes versus secular rural landscapes between the end of the Ancient world and the Middle Ages: the cases of Campo de Hellín and Balazote River Valley (Albacete)**

*Julia Sarabia-Bautista*

9:10-9:30

**Forgotten Early Medieval Landscapes: The Archaeological Analysis of the Village of Combarro (San Vicente de Trigás, Mondoñedo)**

*Celtia Rodríguez-González; José Carlos Sánchez-Pardo*



9:30-9:50

**Continuity and Transformation: Evolution of Rural Landscapes in the Aftermath of Medieval Desertions (South Bohemia)**

*Tereza Šálková; Libor Vobejda; Jan Ciglbauer; Jan Török; Jan John; Erik Hieke*

9:50-10:10

**Landscapes of Desertions during the postclassic period in the Basque Country**

*Juan Antonio Quirós Castillo*

10:10-10:30

Discussion •

ROOM 4

**SESSION 19. Desert and fluvial landscapes. Lights and challenges of landscape archaeology projects in the Theban area (Egypt)**

CHAIRS: *Jesús Martínez Fernández; Ángeles Jiménez Higuera; Antonio J. Morales Rondán*

8:30-8:50

**Unveiling dependency networks and sacred spaces through landscape analysis in the Theban necropolis**

*Antonio Morales; Sergio Alarcón Robledo; Jesús Martínez Fernández; Katherine Emogene Rose*

8:50-9:10

**Remote sensing studies in the Theban Valley: towards a comprehensive study of the Nilotic paleolandscape**

*Jesús Martínez Fernández*

9:10-9:30

**DEM Generation in the Theban Area: Results and Methodological Reflections**

*Katherine Emogene Rose*

9:30-9:50

**The ETSAQ project in Luxor (Egypt): Study of the territory of Sheikh Abd el-Qurna, an analysis based on Landscape Archaeology**

*Ángeles Jiménez-Higuera*

9:50-10:10

**A fluvial landscape inside the Theban necropolis: The Wadi Hatasun and TT 209**

*Daniel M. Méndez Rodríguez; María González Rodríguez; Miguel Ángel Molinero Polo*

10:10-10:30

Discussion •

13 June THURSDAY

**ROOM 5**

**SESSION 4.** All Watched Over by Machines of Loving Grace - Challenges and opportunities in the application of machine learning in landscape archaeology

CHAIRS: *Susan Curran; Jürgen Landauer; Simon Maddison; Axel G. Posluschny; Agnes Schneider*

8:30-8:50

Are we there yet? Desiderata to bridge the gap between FAIR principles to FAIR practices in archaeological remote sensing

*Agnes Schneider*

8:50-9:10

Developing the Automatic Detection of Archaeological Features (ADAF) tool  
*Susan Curran; Anthony Corns; John O'Keefe; Žiga Kokalj; Nejc Čož; Dragi Kocev; Ana Kostovska*

9:10-9:30

From find-spots to landscapes: How to integrate AI into state wide heritage management

*Jürgen Landauer; Ruth Beusing; Axel Posluschny*

9:30-9:50

The changing lived-in landscape between the Copper and Bronze Ages in south-eastern Italy through the lens of machine learning.

*Enrico Lucci*

9:50-10:10

Exploring the relationship between grain shape and environmental conditions through the combination of micrometric 3D scanning, morphometrics, and deep learning

*Hector A. Orengo; Felipe Lumbreras; Javier Esmoris; Iban Berganzo-Besga; Paloma Aliende; Michael P. Wallace; Borja Urbistondo; Ioannis Mylonas; Elissabet Ninou; Alexandra Kriti; Alexandra Livarda*

10:10-10:30

Discussion •

**ROOM 6**

**SESSION 6.** The noble landscape and its residence: The powerful intersection of art, architecture and environment

CHAIRS: *Cato Leuraers; Sanne Maekelberg*



8:30-8:50

**Cultivating Status: Noble Landscape and Garden Architecture in the Southern Low Countries**

*Sanne Maekelberg*

8:50-9:10

**Reconstructing the water landscape of the Ducal Palace of Vila Viçosa (Portugal) through historical sources and GIS technology**

*Pablo Gumiel Campos*

9:10-9:30

**The Inside Out Landscape of a Noble Residence in the Southern Low Countries**

*Cato Leuraers*

9:30-9:50

**Beyond the Walls: Contextualizing Premodern Classical Chinese Gardens in Regional Landscape Making**

*Zheming Cai; Bin Li*

9:50-10:10

**Discussion •**

ROOM 7

**SESSION 23. What is next? Methodological solutions for the study of archaeological landscapes: Comparative perspectives**

CHAIRS: *Jagoba Hidalgo Masa; Carolina Castuera Bravo; Darío Garrido Almagro; Andrea Solana-Muñoz*

8:30-8:50

**Different ways to study past landscapes: spatial analysis, historic modelling and reconstructions.**

*Pedro Trapero Fernández*

8:50-9:10

**Systematic surveys and contextual analysis of evidence in the Sibaritide area (Northern Calabria)**

*Giuseppe Valentini; Alessandro Vanzetti*

9:10-9:30

**How to integrate datasets from different landscape-archaeological approaches? Studying the hinterland of Regina Turdulorum (Casas de Reina, Badajoz, Spain)**

*Günther Schörner; Víctor Martínez Hahn Müller; Anna Maria Mercuri*

13 June THURSDAY

9:30-9:50

**Transhumance and the formation of landscapes: livestock mobility in Devon (UK)**

*Guillem Domingo Ribas; Francesco Carrer; Sam Turner*

9:50-10:10

**Post-medieval terraced landscapes. Methodologies, approaches and results from researches in the Ligurian Apennines**

*Caterina Piu; Sabina Ghislandi; Ivano Rellini; Anna Maria Stagno*

10:10-10:30

**Discussion •**

**ROOM 8**

**SESSION 30. Water uses in rural economic activities: evidences for the Roman period in Hispania and the Roman West**

CHAIRS: *Pedro Trapero Fernández*

8:30-8:50

**Research Methodology for the Management of the Historical Landscape of Water Wells**

*José Antonio Ruiz Gil; Javier Catalán González*

8:50-9:10

**Understanding landscape through water management in the suburban territory of Augusta Emerita.**

*Jesús García Sánchez; Carlos Cáceres Puerto; Santiago Feijoo; Diego Gaspar Rodríguez*

9:10-9:30

**Living on Loess: a case of rainwater-fed agriculture from the northern fringes of the Roman West and Early Middle Ages**

*Roeland Emaus*

9:30-9:50

**L'Assut de l'Argamassa (Elche, Alicante): A Roman Hydraulic Structure in the ager Ilicitanus**

*Jaime Molina Vidal; Daniel Mateo Corredor*

9:50-10:10

**Water resources as a pole of economic attraction in the ancient world. Case studies on the Vía de la Plata (Spain).**

*Beatriz González Montes; José Avelino Gutiérrez González; Pedro Mateos Cruz*

10:10-10:30

**Discussion •**



**SESSION 33.** Maritime Frontiers: insular landscapes, agency, and identity

CHAIRS: *Veronica Walker Vadillo; Kristin Ilves*

8:30-8:50

**Introductory Remarks and presentation of zomia framework**

*Veronica Walker Vadillo; Kristin Ilves*

8:50-9:10

**Towards an Integral Management of the Fortified Maritime Cultural Landscape of Tierrabomba Island: Identity, Communities and Climate Change in Cartagena de Indias, Colombia**

*Jesús Aldana; Carlos Del Cairo; Mariana Carulla; Mónica Orduña; Carlos Reina; Andrés López; Victoria Báez; Liliana Rozo; Saul Vallejo*

9:10-9:30

**The resilient social world of a volcanic island in central Vanuatu, southwest Pacific**

*Robert Henderson; Stuart Bedford; Salkon Yona; Jack Sarginson*

9:30-9:50

**More than Maritime**

*Petter I. Larsson*

9:50-10:10

**Island ports and harbours as border spaces. The case of Sardinia (Italy) between the Middle Ages and the Modern Age**

*Alessandro Panetta; Luciano Gallinari; Sebastiana Nocco; Giovanni Serreli*

10:10-10:30

**Discussion •**

10:30-11:30

**Coffee Break**

13 June THURSDAY

**ROOM 1**

**SESSION 3.** Ecology and archaeology of forest land use legacies: charcoal analysis as analytical tools of human-induced changes

CHAIRS: *Mauro Buonincontri; Claudia Speciale; Bàrbara Mas*

11:30-11:50

**First results of the comparative analysis of human impact on the vegetation of the small islands around Sicily (SILVA)**

*Claudia Speciale; Ethel Allué*

11:50-12:10

**Habitat and woodland use in the Tyrrhenian coastal plain of Tuscany (central Italy) from Roman to Medieval times.**

*Mauro Buonincontri; Gaetano Di Pasquale*

12:10-12:30

**Discussion •**

**ROOM 2**

**SESSION 8.** What are you doing here?

CHAIRS: *Marta Francés-Negro; Izaro Quevedo-Semperena*

11:30-11:50

**XRF portable: a methodological comparison with “traditional” measurements.**

*Marta Francés-Negro; Julián Cuesta Romero; Jesús García Sánchez; Ignacio Ruiz Vélez.*

11:50-12:10

**“They came bearing gifts”: the “exotic” objects from Horta do João da Moura’s tholoi tombs (Ferreira do Alentejo, Portugal)**

*Mónica Corga; Miguel Almeida; Thierry Aubry; Sílvia Aires.*

12:10-12:30

**Discussion •**

**ROOM 3**

**SESSION 16.** Landscapes of Desertions. Social memories, political practices and identities in a long-term perspective

CHAIRS: *Lukáš Holata; Carlos Tejerizo-García*

11:30-11:50

**Abandonment or Persistence? Rethinking Landscapes of Desertions in the Czech Republic**

*Lukáš Holata*





11:50-12:10

**Enforced desertion and displacement, a landscape archaeology of destruction and disruption, re-location and re-habitation.**

*Graham Fairclough; Julia van Duijvenvoorde; Stelios Lekakis; Thomas Meier; Sam Turner; Nikola Vuletic*

12:10-12:30

**Deserted settlements as arenas of struggle in the age of supermodernity: a case study in rural northwestern Iberia**

*Carlos Tejerizo; Cristina Incio del Río*

12:30-12:50

**How green was my valley: Challenges and proposals for the management and revaluation of the heritage submerged in Spanish reservoirs. Memory reparation and restitution**

*Lucas Cepeda Fernández-Escandón*

12:50-13:10

**Discussion •**

ROOM 4

**SESSION 19. Desert and fluvial landscapes. Lights and challenges of landscape archaeology projects in the Theban area (Egypt)**

*CHAIRS: Jesús Martínez Fernández; Ángeles Jiménez Higuera; Antonio J. Morales Rondán*

11:30-11:50

**“With the Street Between Them”. An Approach to the Street System of the Theban Necropolis in the Late Period**

*Alfonso Martín Flores; Miguel Ángel Molinero Polo*

11:50-12:10

**Desert rocks: archaeological lithic record as an indicator of the landscape diachronic use in the Hatasun wadi (Luxor, Upper Egypt)**

*Cristo M Hernández; Alejandro Mayor Benadero; Miguel Ángel Molinero Polo*

12:10-12:30

**Landscape archaeology, cultural memory and significant geography in the West Bank, Luxor: the C2 Project.**

*José Ramón Pérez-Accino; Hisham El-Leithy*

12:30-12:50

**Discussion •**

13 June THURSDAY

**ROOM 5**

**SESSION 4.** All Watched Over by Machines of Loving Grace - Challenges and opportunities in the application of machine learning in landscape archaeology

CHAIRS: *Susan Curran; Jürgen Landauer; Simon Maddison; Axel G. Posluschny; Agnes Schneider*

11:30-11:50

**Machine Learning in LiDAR-based and optical imagery prospection in archaeology: challenges and potentialities**

*Arianna Traviglia; Giulio Poggi; Gregory Sech; Andaleeb Yaseen; Raveerat Jaturapitpornchai; Marco Fiorucci*

11:50-12:10

**Pre-Hispanic landscape occupation in Chilean Andes. A Remote Sensing and Deep-Learning coupled approach**

*Maria Elena Castiello; Jürgen Landauer; Thibault Saintenoy*

12:10-12:30

**Discussion •**

**ROOM 6**

**SESSION 13.** Tracking (in)visible states and Domestic Spaces through Microarchaeology from Protohistory to Roman times: Iberia and North Africa

CHAIRS: *Ariadna Guimerà Martínez; Marta Mateu Sagués*

11:30-11:50

**Plant-processing activities and spatial distribution in the Eastern Pyrenees: first phytolith studies of grinding stones**

*Ariadna Guimerà; Marta Portillo*

11:50-12:10

**What can micromorphology bring to studying domestic spaces? Occupation deposits vs occupation layers**

*Marta Mateu; Carme Belarte*

12:10-12:30

**What was found embedded in the floor? Domestic activities at Las Eras del Alcázar (Úbeda-Jaén) through phytolith and calcitic microfossil evidence**

*M. Victoria García*



12:30-12:50

**New perspectives on the Mauritanian urban phenomenon through microstratigraphic evidence: The Eastern Quarter of Tamuda (Tetouan, Morocco)**

*Mario Gutiérrez; Darío Bernal*

12:50-13:10

**Discussion •**

ROOM 7

**SESSION 23.** What is next? Methodological solutions for the study of archaeological landscapes: Comparative perspectives

CHAIRS: *Jagoba Hidalgo Masa; Carolina Castuera Bravo; Darío Garrido Almagro; Andrea Solana-Muñoz*

11:30-11:50

**Identifying the “intruder”: Geomorphometric proposal for the identification of Iron Age defensive enclosures through GIS and remote sensing**

*Andrea Solana Muñoz*

11:50-12:10

**“Trust me, that’s another hillfort”: The applicability of remote sensing to investigate fortified sites in challenging landscapes for archaeological prospection**

*Rodrigo González-Camino; David González-Álvarez*

12:10-12:30

**Hillforts, war and pines. A methodological proposal based on Civil War orthophotos to characterize Iron Age settlements.**

*Jagoba Hidalgo-Masa*

12:30-12:50

**“Lights and shadows” of the method: the challenges of metal detecting in the analysis of the Second Punic War conflict.**

*Carolina Castuera Bravo; Miguel Ángel Lechuga Chica; Juan Pedro Bellón Ruiz; Carmen Rueda Galán; María Isabel Moreno Padilla; Darío Garrido Almagro*

12:50-13:10

**Archaeoastronomy from the air. Digital tools in the study of Roman landscapes and skylscapes**

*Andrea Rodríguez-Antón; A. César González-García; Giulio Magli*

13:10-13:30

**Discussion •**

13 June THURSDAY

**ROOM 8**

**SESSION 30.** Water uses in rural economic activities: evidences for the Roman period in Hispania and the Roman West

CHAIRS: *Pedro Trapero Fernández*

11:30-11:50

**Water and Roman stone working: Reassessing the hydraulic complex of Tanque dos Mouros (Estremoz, Portugal) in a landscape of marble exploitation**

*Gil Vilarinho*

11:50-12:10

**Roman Dams and reservoirs Systems in Lusitania: Question State with GIS and Spatial Data from the Alentejo Region**

*André Carneiro; Pedro Trapero Fernández*

12:10-12:30

**Water Uses in a Suburban Agricultural Establishment in Northeastern Hispania: The Roman Villa of Pla de l'Horta (Sarrià de Ter, Gerona).**

*Ana Costa*

12:30-13:10

**The Use and Exploitation of Water in the Roman Villa of Pisões and Its Dam: Contributions from Geophysics and Topographic Analysis**

*Pedro Trapero Fernández; Rui Jorge Oliveira; Bento Caldeira; André Carneiro*

13:10-13:30

**Discussion •**

**ROOM 9**

**SESSION 33.** Maritime Frontiers: insular landscapes, agency, and identity

CHAIRS: *Veronica Walker Vadillo; Kristin Ilves*

11:30-11:50

**Insular Connectivity – Autonomy and Interdependence in Viking Age settler communities on the Northern Isles of Scotland**

*Charlotta Hillerdal*

11:50-12:10

**Ancient Interactions in the Maritime Peripheries of Northeast Asia and the Formation of a Hwandonghae Region**

*Ilhong Ko*



12:10-12:30

**From the ashes they rise: crafting insular resilience and group identity in times of environmental catastrophe**

*Veronica Walker Vadillo; Kristin Ilves*

12:30-12:50

**Final discussion**

*Veronica Walker Vadillo; Kristin Ilves*

12:50-13:10

**Discussion •**

POSTER  
SESSION

From June 10 to 14 THURSDAY

ROOM MAIN HALL

**SESSION 35.** Poster Session

CHAIRS: *Scientific Committee*

P 1

**We Are But A Part of This World: Tracing Human-Environmental Entanglement from the Middle/Late Pleistocene through the Holocene. (PhD Dissertation)**

*Andrea Pintar; Sjoerd Kluiving*

P 2

**Contesting the role of economic drivers and responses in historical energy regime transitions; drivers or consequences?**

*Alexandre Martinez; Sjoerd Kluiving; José Muñoz-Rojas; César Borja Barrera; Pablo Fraile Jurado;*

P 3

**The landscape may not have been as species-poor in the Ice Age as previously thought – a new hypothesis for Central Europe**

*Marianna Biró; Ábel Péter Molnár; László Demeter; Milan Chytrý; Sándor Bartha; Batdelger Gantuya; Zsolt Molnár*

P 4

**Tor dei Pagà (Vione, Valcamonica - Italy): the local environment and its exploitation in the Iron Age and Later Medieval period**

*Delia Fanetti; Elisabetta Castiglioni; Michela Cottini*

POSTER  
SESSION

AUTHORS OF THE POSTERS MUST BE AVAILABLE IN THE POSTER AREA  
TO ANSWER QUESTIONS FROM THE PARTICIPANTS IN THE CONFERENCE

P 5 ■■■

**Trans-Mediterranean Greco-Roman landscapes. An integrated comparative study around Abdera (Greece) and Emporion (Spain).**

*Isabel Mattuzzi; Merkouris Georgiadis; Eurydice Kefalidou; Josep Maria Palet; Arnau Carbonell; Constantina Kallintzi; Alfredo Mayoral; Arnau Garcia-Molsosa*

P 6 ■■■

**(Late) Holocene landscape development of the lower Bakırçay plain (Pergamon Micro-Region, western Türkiye) and its modern alteration**

*Joris Starke; Fabian Becker; Robert Busch; Bernhard Ludwig; Moritz Nykamp; Brigitta Schütt*

P 7 ■■■

**Space, time, territory and landscape in the megasites of the 3rd millennium**

*Francisco Sánchez Díaz; Leonardo García Sanjuán*

P 8 ■■■

**The semi-automatic vectorization of historical maps - Example of vectorization of maps of imperial imprints of the stable cadastre of the village Kámen and the town Kraslice**

*Klára Hanáková*

P 9 ■■■

**The Ironworking Landscape - the example of Brdy Mountains, the Czech Republic**

*Tomáš Kroupa*

P 10 ■■■

**Resources of Animal Products in Medieval settlements of Moldavian Plain (NE Romania)**

*BEJENARU Luminita; Stanc Margareta Simina*

P 11 ■■■

**Paleoenvironmental research in the hinterland of Göbekli Tepe, SE Türkiye**

*Moritz Nykamp; Fabian Becker; Brigitta Schütt*

P 12 ■■■

**Approaching territorial patterns in Late Prehistory in the Campo de Montiel (Albacete). The case of Cerro de la Encantada**

*Marta Torres*

P 13 ■■■

**Cityscape and Collective Memory: Clandestine Materialities of WWII Polish Refugees in Iran**

*Maryam Naeimi*



12 June WEDNESDAY

15:00-16:00 h

P 14 ■■■

**Reconstruction of the Historical Landscape through the Results of Macroremains Analysis from the Great Moravian Hillfort Neštich (Svätý Jur, Slovakia)**

*Natália Hurajtová*

P 15 ■■■

**Relics of medieval cultivation in current forest flora of Svätý Jur, Slovakia**

*Petra Gašparovičová; Natália Hurajtová; Veronika Piscová*

P 16 ■■■

**Tracing pathways: the funerary landscape and the spreading of metal technology in the Southern Caucasus (4th-1st mill. BC)**

*Stefania Fiori*

P 17 ■■■

**Bioarchaeological Remains from sites of Iasi City (NE Romania) in view of economic and environmental evaluation**

*Stanc Margareta Simina; DANU Mihaela; PIRNAU-BACUMENCO Ludmila; BILAVSCHI George; MOTOTOLEA Constantin Aurel; BEJENARU Luminita*

P 18 ■■■

**Reconstruction of Medieval landscape to the East of Carpathian based on phytolith and archaeozoological analyses**

*Stanc Margareta Simina; BEJENARU Luminita; DANU Mihaela*

P 19 ■■■

**Reuse, Christianity, borders and contemporaneity: Historical notes about the megalithic evolution of the Gipuzkoan landscape.**

*Izaskun Egilegor Uranga*

P 20 ■■■

**Finding a place for nature and heritage: Investigating the relationship between cultural heritage management and the rewilding movement in Britain**

*Robert Swinbank*

P 21 ■■■

**Hidden places? A preliminary approach to testing the visual perception visibility surrounding funerary caves during the Early Neolithic in the Maciço Calcário Estremenho (Portugal)**

*Helena Reis; António Valera; Célia Gonçalves*

CONFERENCE  
FIELD TRIPS

To complement the Conference Sessions the LAC2024 Organising Committee has arranged 2 field trips for June 14. Both archaeological sites are located approximately 1 hour from Alcalá.

- Departure from the conference venue at 9.30 am
- Return to the same point 2 pm
- Participant numbers in each trip are limited
- Time and departure locations are subject to change
- Each field trip will be guided by an expert on the archaeological site.

**RECCOPOLIS: A VISIGOTHIC URBAN FOUNDATION**

**Zorita de los Canes, Guadalajara**

Reccopolis is the sole archaeologically-attested Visigothic city founded in the Iberian Peninsula. Created under King Leovigild in A.D. 576, the city played a notable role in the landscape, persisting as the focal point of the territory through to the 8th century AD. This visit offers an overview of the most recent results from the project undertaken in and around Reccopolis, which in the last two decades has concentrated on the principal building structures of the city and has drawn much from the discipline of Landscape Archeology, enabling a fuller understanding of the agrosystem, the character and structure of rural occupation and exploitation, and a greater awareness of environmental conditions across the Early Middle Ages in the territory of the Central Plateau of the Iberian Peninsula.

***Lauro Olmo-Enciso***

Professor of Archaeology. Universidad de Alcalá





### **THE VALLEY OF THE NEANDERTHALS ARCHAEOLOGICAL PARK** **Pinilla del Valle, Madrid**

The Valley of the Neanderthals Archaeological Park is situated 100 km north of Madrid. It is home to several karst sites from the Middle and Late Pleistocene, located on a small hill overlooking the Pinilla reservoir. The park boasts a natural environment of high ecological value and is situated close to the Sierra de Guadarrama National Park. These sites are rich in paleontological and archaeological evidence, with numerous occupations from the Middle and Upper Paleolithic periods. The Des-Cubierta Cave, one of the most notable sites in the park, contains an accumulation of large mammal crania produced by Neanderthals, which is believed to be the strongest evidence of their symbolic behaviour in relation to the prey they hunted and consumed.

***Belén Marquez Mora and Cesar Laplana***

The Neanderthals Valley Archaeological Research Team

---

Please note that it is mandatory to be registered for the conference to participate in this activity. Participants must also sign up in advance.

10-14 JUNE.  
ALCALÁ UNIVERSITY. SPAIN

HUMAN CHALLENGES IN A CONTEXT  
OF CHANGING LANDSCAPES

LANDSCAPE  
ARCHAEOLOGY  
CONFERENCE

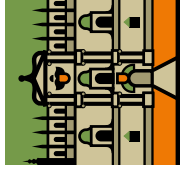

LAC 2024

**Monday 10 June**

**Colegio de San Ildefonso - Rectorado**

From 12:00	<b>Check-in for participants opens</b>
16:00-16:30	Institutional Welcome
16:30-17:15	Inaugural Conferences
17:15-18:00	
18:00- 18:45	
19:00-20:30	Welcome Reception

Location of Rooms: Colegio de San Ildefonso-Rectorado: Room 1 & Room 2 - Colegio de Málaga-Facultad de Filosofía y Letras: Rooms 3, 4, 5, 6, 7, 8 & 9.

## Tuesday 11 June

	Room 1	Room 2	Room 3	Room 4	Room 5	Room 6	Room 7	Room 8	Room 9	Museum
<b>Start</b>	Session 7	Session 34	Session 5	Session 12	Session 20	Session 1	Session 9	Session 22	Session 26	
8:30-8:50										
8:50-9:10										
9:10-9:30										
9:30-9:50										
9:50-10:10										
10:10-10:30	Discussion	Discussion	Discussion	Discussion	Discussion	Discussion	Discussion	Discussion	Discussion	
<b>Break</b>										
11:30-11:50										
11:50-12:10										
12:10-12:30		Discussion								
12:30-12:50										
12:50-13:10	Discussion		Discussion	Discussion		Discussion	Discussion	Discussion	Discussion	
<b>Lunch</b>										
15:00-15:20						Session 32	Session 27			
15:20-15:40					Discussion					
15:40-16:00										
16:00-16:20			Discussion	Discussion		Discussion	Discussion	Discussion	Discussion	
<b>Break</b>										
17:00-17:20										IALA General Assembly
17:20-17:40										
17:40-18:00								Discussion		Museo Arqueológico y Paleontológico
18:00-18:20						Discussion				
18:20-18:40	Discussion									
18:40-19:30										

Location of Rooms: Colegio de San Ildefonso-Rectorado: Room 1 & Room 2 - Colegio de Málaga-Facultad de Filosofía y Letras: Rooms 3, 4, 5, 6, 7, 8 & 9.

## Wednesday 12 June

	Room 1	Room 2	Room 3	Room 4	Room 5	Room 6	Room 7	Room 8	Room 9	Main Hall
<b>Start</b>	Session 15	Session 11	Session 10	Session 2	Session 17	Session 18	Session 14	Session 25	Session 29	
8:30-8:50										
8:50-9:10										
9:10-9:30										
9:30-9:50										
9:50-10:10										
10:10-10:30	Discussion	Discussion	Discussion	Discussion	Discussion	Discussion	Discussion	Discussion	Discussion	
<b>Break</b>										
11:30-11:50										
11:50-12:10										
12:10-12:30							Discussion			
12:30-12:50										
12:50-13:10	Discussion	Discussion	Discussion	Discussion	Discussion	Discussion	Discussion	Discussion	Discussion	
<b>Lunch</b>										
15:00-15:20						Session 21	Session 24			Session 35 (Poster Session)
15:20-15:40								Discussion		
15:40-16:00										
16:00-16:20	Discussion	Discussion	Discussion		Discussion	Discussion	Discussion			
<b>Break</b>										
17:00-17:20										
17:20-17:40										
17:40-18:00										
18:00-18:20						Discussion				
18:20-18:40	Discussion									

Location of Rooms: Colegio de San Ildefonso-Rectorado: Room 1 & Room 2 - Colegio de Málaga-Facultad de Filosofía y Letras: Rooms 3, 4, 5, 6, 7, 8 & 9.

## Thursday 13 June

	Room 1	Room 2	Room 3	Room 4	Room 5	Room 6	Room 7	Room 8	Room 9
<b>Start</b>	Session 3	Session 8	Session 16	Session 19	Session 4	Session 6	Session 23	Session 30	Session 33
8:30-8:50	Discussion	Discussion	Discussion	Discussion	Discussion	Discussion	Discussion	Discussion	Discussion
8:50-9:10									
9:10-9:30									
9:30-9:50									
9:50-10:10									
10:10-10:30									
<b>Break</b>									
11:30-11:50	Discussion	Discussion	Discussion	Discussion	Discussion	Session 13	Discussion	Discussion	Discussion
11:50-12:10									
12:10-12:30									
12:30-12:50									
12:50-13:10									

Location of Rooms: Colegio de San Ildefonso-Rectorado: Room 1 & Room 2 - Colegio de Málaga-Facultad de Filosofía y Letras: Rooms 3, 4, 5, 6, 7, 8 & 9.

## Friday 14 June

Conference Field Trips	
<b>Depart</b> 9:30	The Valley of the Neanderthals Archaeological Park
<b>Arrival</b> 14:00	

Departure and return near the conference Venue

# LAC 2024

LANDSCAPE  
ARCHAEOLOGY  
CONFERENCE



PLAZA CERVANTES

PLAZA  
SAN DIEGO

COLEGIO  
SAN ILDEFONSO  
UNIVERSIDAD  
DE ALCALA DE  
HENARES



CHECK-IN  
ROOM 1  
ROOM 2

ROOM 1  
GROUND FLOOR

ROOM 2  
FIRST FLOOR

LUNCH  
AREA  
COFFEE  
AREA

CLOISTER

**CALLE COLEGIOS**

**UAH - COLEGIO  
DE MÁLAGA**  
FACULTAD  
DE FILOSOFÍA  
Y LETRAS

**Scan the QR code**  
for the walking route  
to and from the  
University and San  
Ildefonso





LANDSCAPE  
ARCHAEOLOGY  
CONFERENCE



**UAH - COLEGIO DE MÁLAGA**  
FACULTAD DE FILOSOFÍA Y LETRAS

**CALLE  
COLEGIOS**

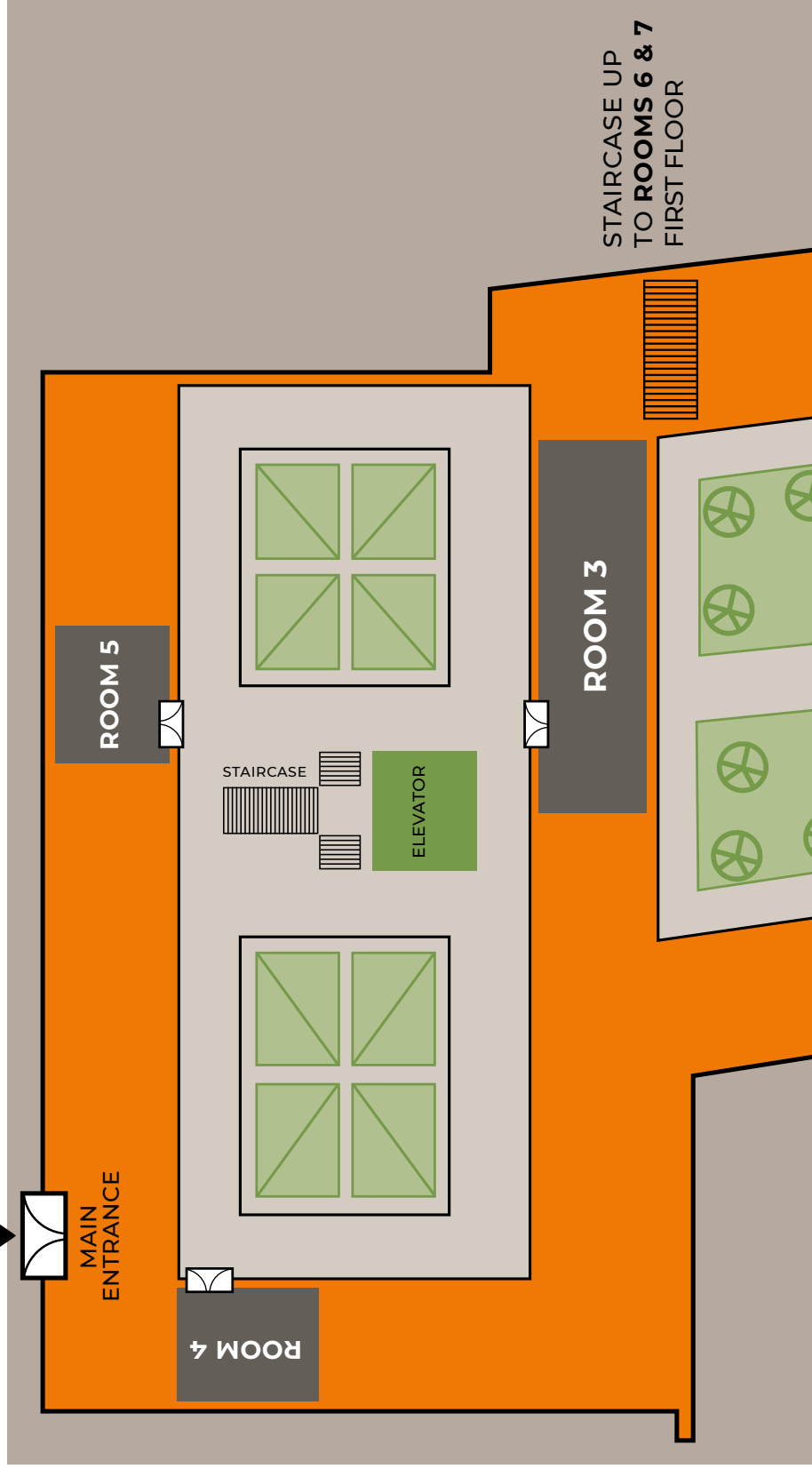





**Rooms 1 & 2**  
are in the **Colegio**  
**San Ildefonso**  
building  
Scan the QR code  
for the walking route  
to and from the  
University and San  
Ildefonso



PRACTICAL  
INFORMATION



### THE VENUE

The conference will be held at the Colegio San Ildefonso-Rectorado and the Colegio de Málaga-Facultad de Filosofía y Letras. Both buildings are located in the historic centre of Alcalá de Henares within 4 minutes walking distance from each other.

Plenary and parallel sessions will be held in both buildings.

The San Ildefonso-Rectorado College will serve as the main building for the conference activities. There you will find the check-in & information office, which will always be attended by the technical secretary of the event. Also in this building you will find the Salón de Actos (Room 1) where the plenary events will be held. As the capacity is limited, when it is full the events will be broadcast by streaming to other rooms. We will let you know which room to go to when you arrive. In this building you will find the lunch and coffee area as well.

There are 9 rooms for the parallel sessions of the conference. Rooms number 1 and 2 are in the Colegio de San Ildefonso-Rectorado and numbers 3 to 9 in the Colegio de Málaga-Facultad de Filosofía y Letras.

**When you arrive at the check-in, you will find maps to help you locate the room you are looking for and a team of volunteers to help you if you have any doubts.**

In the venue, you will be able to access a dedicated wifi line for the conference:

SSID: **lac2024**

Code: **LAC-uah-9122**



## ACCREDITATION -CHECK-IN

Our main objective is to avoid queues by trying to do the accreditation process in a staggered manner.

**10 June:** Early check-in opens from 12:00 and will remain open until 19:00. You are free to come to the venue, pick up your accreditation and familiarise yourself with the venue.

**11, 12 and 13 June:** Open from 8:10 a.m. until the end of the activities at the venue, as we share the check-in space with the information point for attendees.

## INFORMATION ON MEALS

**Welcome Reception, Coffee Breaks, and work lunch (cocktail style)** will be served outdoors in the Historic Cloister of the Colegio de San Ildefonso. For the work lunches no alcohol will be served.

We have informed the catering team of the attendees' diet type and dietary restrictions. They will make every effort to accommodate them where possible.

Once at the venue, please ask if you have any concerns.

## VISITS AND TOURISIM

For those of you coming from outside Alcalá and Madrid, you can get information about how to get around and things to do or visit on the official tourism website of Alcalá <https://visitalcala.es/> or Madrid (<https://www.esmadrid.com/en/tourist-information-centres>)

**We hope you find the conference interesting. Please remember to wear your ID badge during all conference activities.**

## GUIDELINES FOR PRESENTERS

### ORAL PRESENTATIONS

- Your room will be open 20 minutes before the start of your session. Please be on time.
- Make sure you are aware of the time and room of your session. Please note that there are 9 rooms where parallel sessions will take place located in two different buildings. You will find orientation maps in the printed programme, displayed on posters at the venue, and near the information and check-in point. There will also be a group of volunteers willing to help you find where your session will take place or with any other questions you may have.
- Please arrive at your session in time to hand in your presentation to the chair/s of your session.
- Please bring your presentation file (PowerPoint or PDF) stored on a USB device.
- Your presentation file will then be uploaded to a Windows-based computer available in the conference room solely for the purpose of giving the presentation.
- Presentations must be delivered in English and should not be longer than 15-20 minutes. If you exceed this time, your paper may be interrupted by the session chair.
- Please leave the questions to the end of the presentation. Speakers should not be interrupted during their presentation.
- Slides are designed to accompany your presentation, NOT TO BE your presentation. Recorded presentations will not be considered



## POSTER PRESENTATIONS

- It is obligatory to bring your printed poster with the title and authors included. The conference staff will provide materials for fixing it to the presentation boards.
- When you check-in you will be shown the exact place you have been assigned to place your poster.
- Size: 90 X 120 cm. Please note the size of the boards provided by the university is slightly smaller than the size originally specified on the website. If your poster is already completed to the former size, we should be able to adapt it to the boards provided.
- Please, remember that the authors of the posters will have one hour (Wednesday, 12th June) - established in the program - to answer questions from the participants in the congress. During that time, they must be available in the poster area.
- Please do not forget to take your poster with you when the conference ends. We will not be able to return posters left behind.

**ENJOY THE CONFERENCE. THANK YOU!!**

GUIDELINES FOR  
PARALLEL SESSION  
CHAIRS



**BEFORE THE SESSION**

- Your room will be open 20 minutes before the start of your session. You will find the computer and projector ready.
- It is advisable to load all the presentations of your session in a folder to avoid losing time between sessions and to make the transition between presentations smoother.
- Chairs will always be assisted by the organisers and the technical secretary. If you have any technical problems during your session, you should contact the support team who will be monitoring the correct functioning of the equipment in the rooms. There will always be someone identified at the entrance of each building who can be contacted in the event of any problem.
- The following material will be made available to you:
  - A pen drive with the room number. Please remember to leave it in the room so that it can be used in the subsequent sessions.
  - A written list of all submissions included in your session.
  - A highlighter pen.



## DURING THE SESSION

- Please start on time. Introduce yourself, the session's title, and briefly explain the session format.
- Briefly introduce each speaker before their presentation
- Please be very strict with time management. We have encouraged authors in previous communications to prepare presentations not longer than 20 minutes, so that there is always time for discussion.
- Remember to highlight the name/names of the author/authors who give the presentation on the list you have been given (for example, if there are four authors for a paper, only highlight the name/names of the actual presenter/s). This list must be handed in at the information & check-in point which will be located at the entrance of the Colegio de San Ildefonso-Rectorado. Without this list, we will not be able to give the corresponding certificate of presentation if any delegate requires it.
- Make sure the next presenter is ready to begin as soon as the previous one finishes.
- **Discussion:** Please encourage audience members to ask questions. Have a few questions prepared yourself in case the audience is initially reluctant.

## END OF SESSION

- We kindly ask you to let the support team know that your session has ended and that you have left the room..
- Do not forget to hand in the list at the information & check-in point.

## THANK YOU FOR YOUR SUPPORT

10-14 JUNE. ALCALÁ UNIVERSITY. SPAIN

---

HUMAN CHALLENGES IN A CONTEXT OF CHANGING LANDSCAPES



LANDSCAPE  
ARCHAEOLOGY  
CONFERENCE



LAC 2024

HUMAN  
CHALLENGES  
IN A CONTEXT  
OF CHANGING  
LANDSCAPES

## SCIENTIFIC PROGRAMME

LANDSCAPE  
ARCHAEOLOGY  
CONFERENCE

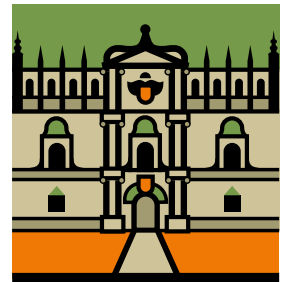

### ORGANIZERS



### COLLABORATORS



# LAC 2024

10-14 JUNE

ALCALÁ UNIVERSITY

SPAIN